

Saab 9000

Service Manual

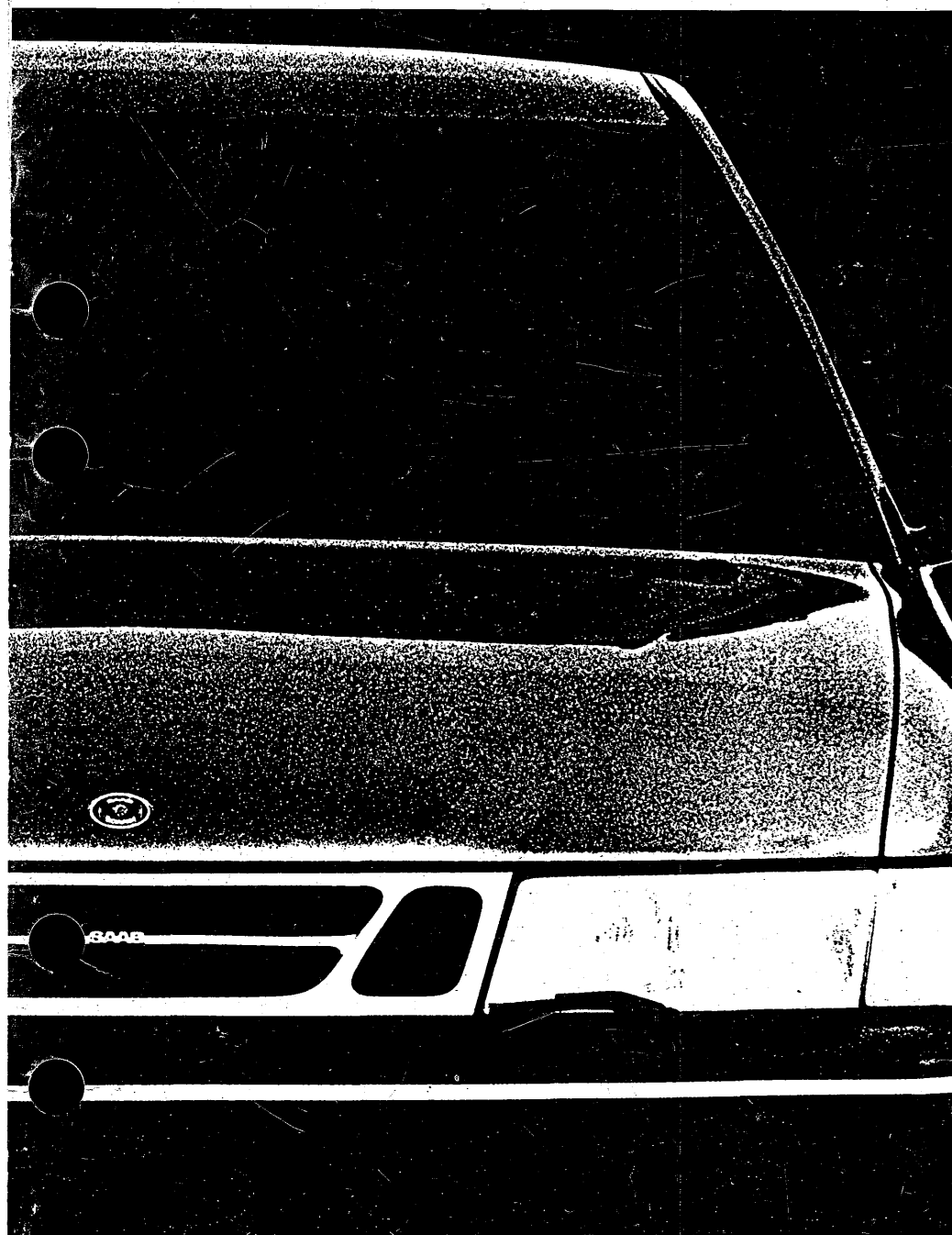

M 1995-

ENG

3:5 Electrical system, Audio System

Saab 9000

SERVICE MANUAL

3:5 Electrical system, Audio System

M 1995–

Foreword

All information and illustrations in this service manual are based on the design of the relevant cars at the time of final editing of this printed matter. Models, technical data and equipment vary from market to market and may be changed without prior notice.

Saab Automobile AB

Special tool	1
Technical description	3
Fault diagnosis	15
Replacing components	29
Connectors and grounding points	47
Electrical diagrams	51



RECYCABLE PAPER

Warning, Important and Note

The headings "Warning", "Important" and "Note" occur from time to time in the Service Manual. They are used to draw the attention of the reader to information of special interest and seriousness. The importance of the information is indicated by the three different headings and the difference between them is explained below.

WARNING

Warns of the risk of material damage and grave injury to mechanics and the driver, as well as serious damage to the car.

Important

Points out the risk of minor damage to the car and also warns the mechanic of difficulties and time-wasting mistakes.

Note

Hints and tips on how the work can be done in a way that saves time and labour. This information is not supplied for reasons of safety.

Market codes

The codes refer to market specifications

AT	Austria	GB	Great Britain
AU	Australia	GR	Greece
BE	Belgium	IS	Iceland
CA	Canada	IT	Italy
CH	Switzerland	JP	Japan
DE	Germany	ME	Middle East
DK	Denmark	NL	Netherlands
ES	Spain	NO	Norway
EU	Europe	SE	Sweden
FE	Far East	US	USA
FI	Finland	UC	US California
FR	France		

Special tools

Tool for removing the radio unit and CD player from the instrument panel.
Part no. 84 71 161.

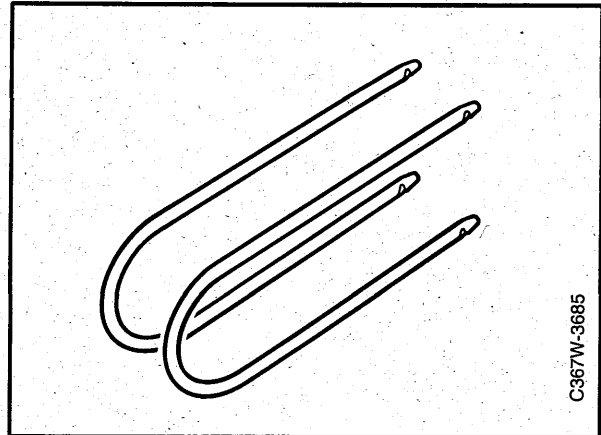

Test lamp
Part No. 86 11 857.

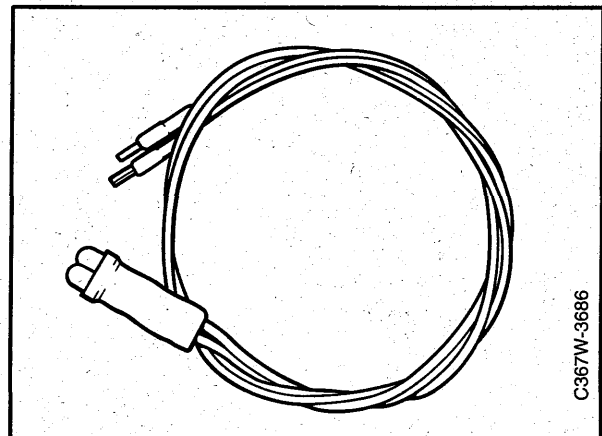

Technical description

Audio system	3	Connections to amplifier, Audio System	
Configuration, Audio System Premium	4	Premium	10
Configuration, Audio System Prestige	5	Connections to amplifier, Audio System	
Power supply	6	Prestige	11
Grounding points	7	Coding of radio and cassette player	12
Audio signal	8	Test functions in the RDS system	13
Connections to radio and cassette player ...	9		

Audio system

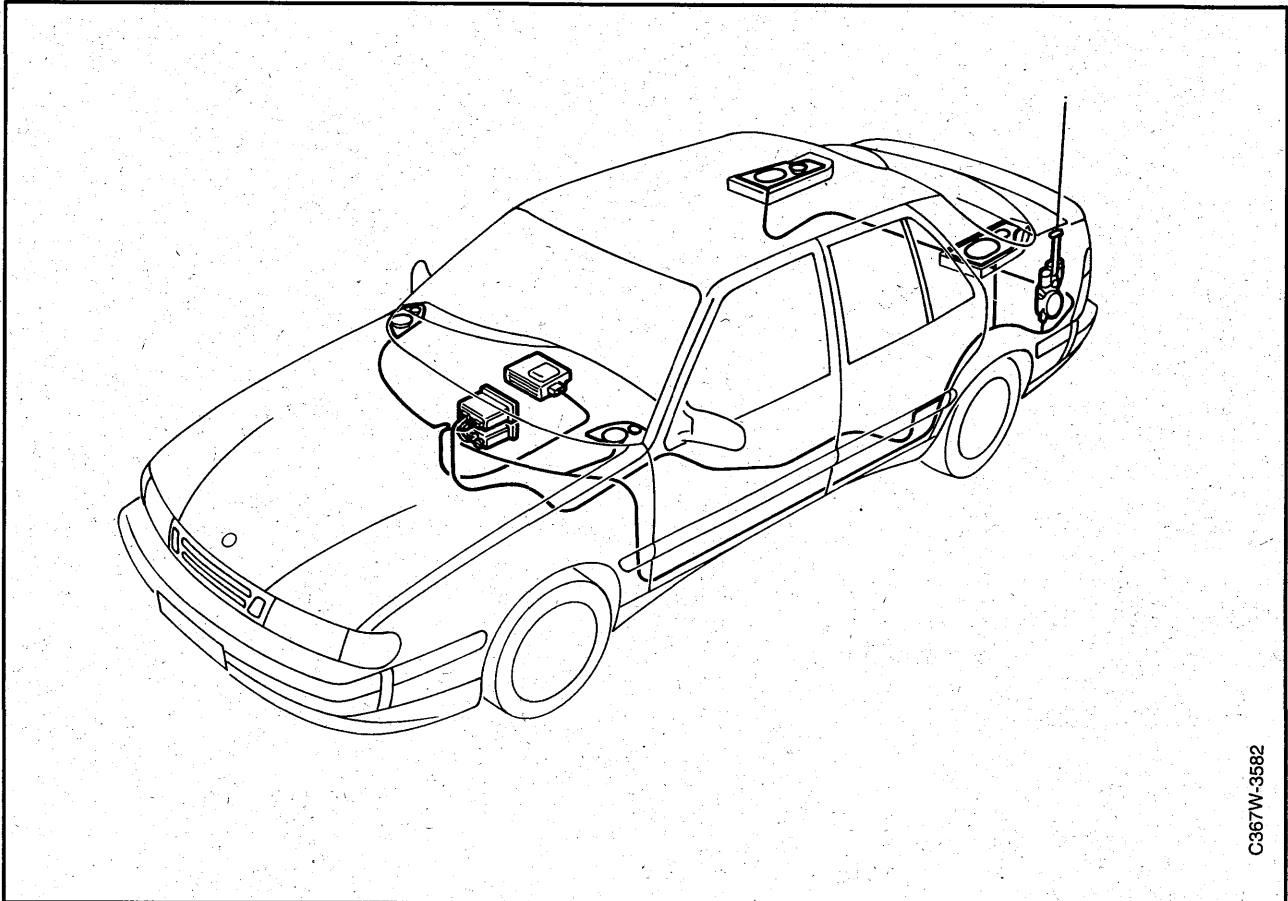

C367W-3582

This Service Manual covers factory-fitted Saab 9000 Audio System as of model year 1995.

Saab 9000 Audio System is available in two variants:

Audio System Premium

available in EU model for Europe and US model for the USA and Canada.

Audio System Prestige

with Harman/Kardon amplifier and speakers (marketed only in the USA and Canada).

For audio system operating instructions, see car owner's manual.

Configuration, Audio System Premium

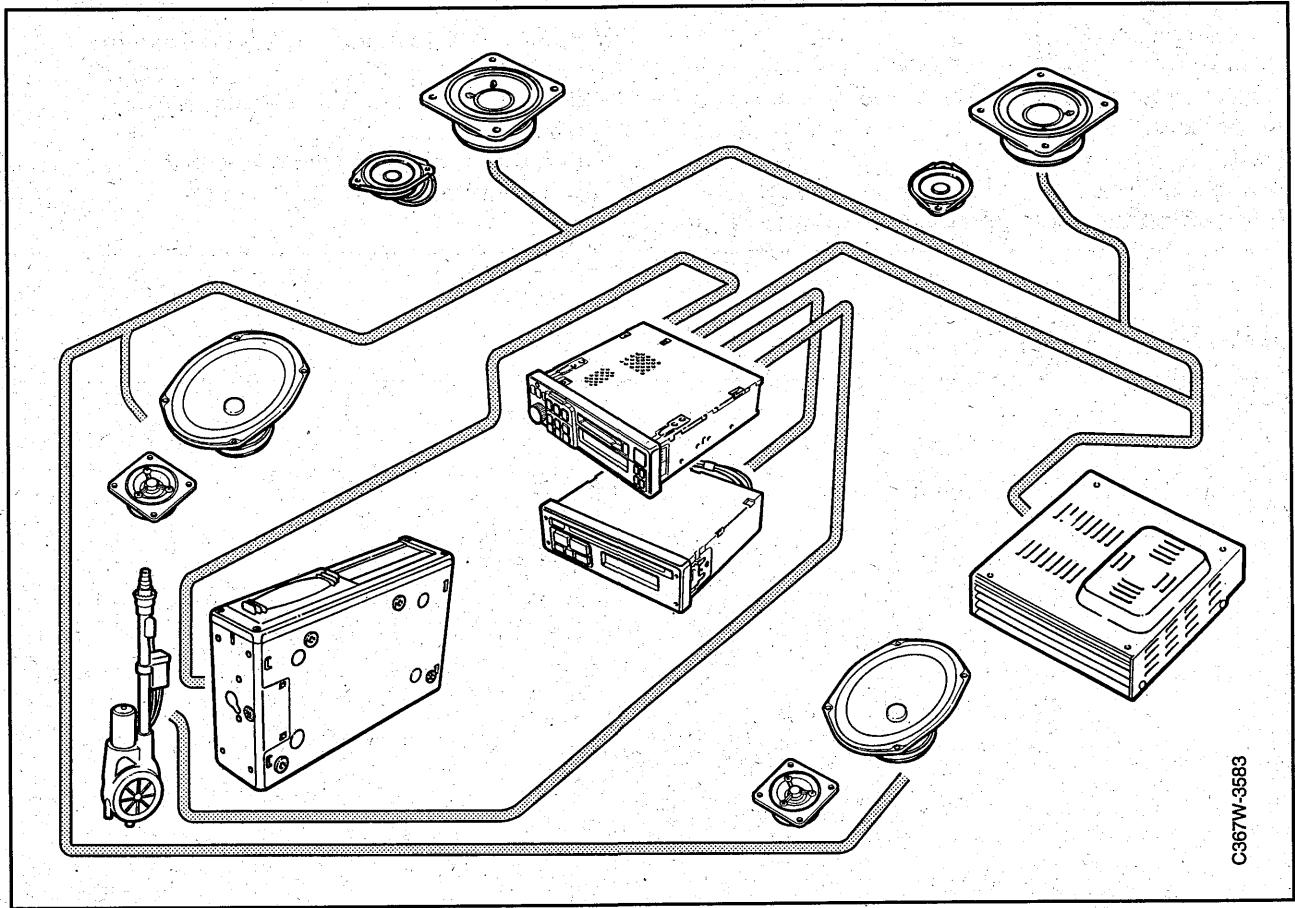

Audio System Premium

consists of the following components:

- Radio and cassette player
- CD player
- CD changer (option)
- Amplifier
- Eight speakers
- Power antenna

Configuration, Audio System Prestige

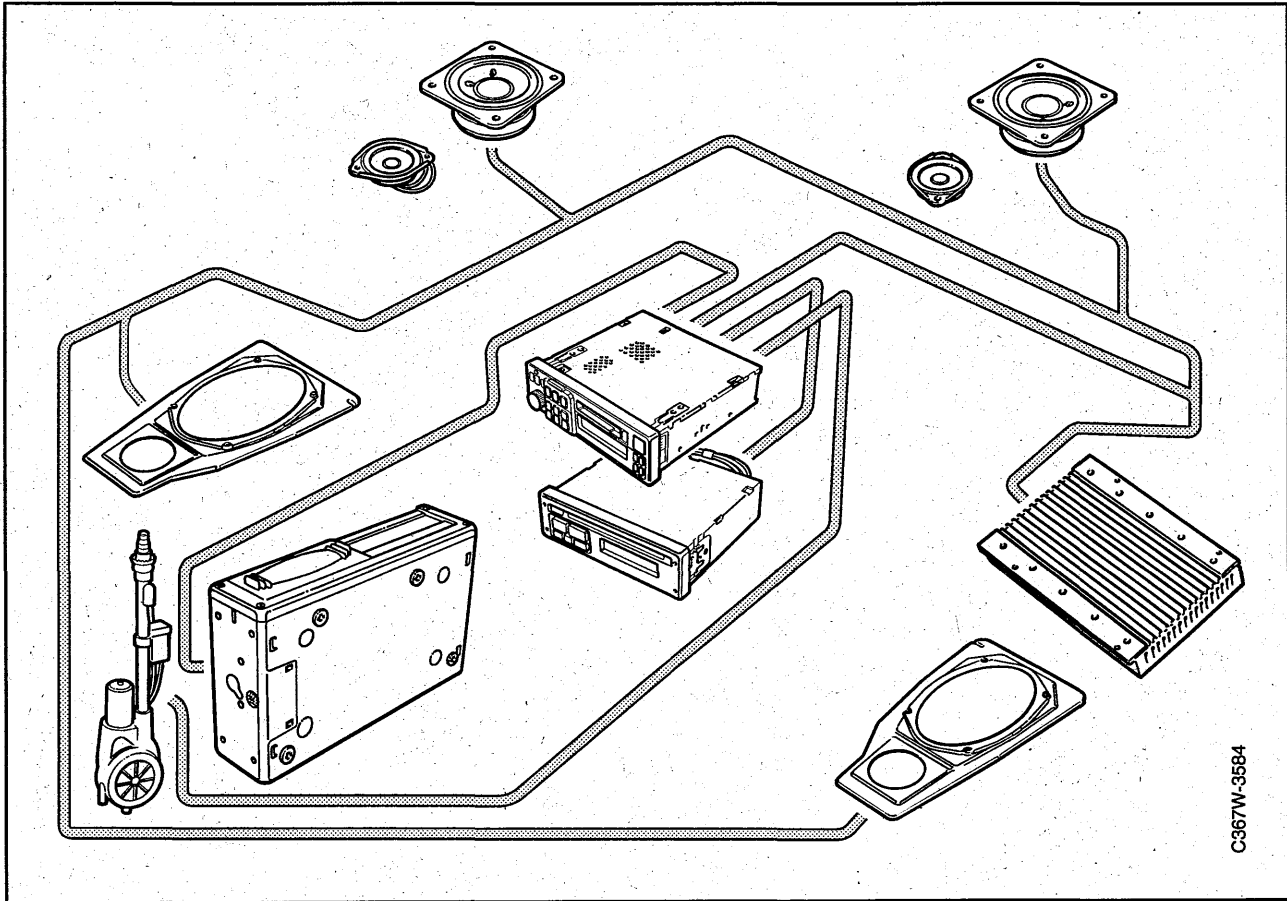

Audio System Prestige

consists of the following components:

- Radio and cassette player
- CD player
- CD changer (option)
- Amplifier
- Ten speakers
- Power antenna

Power supply

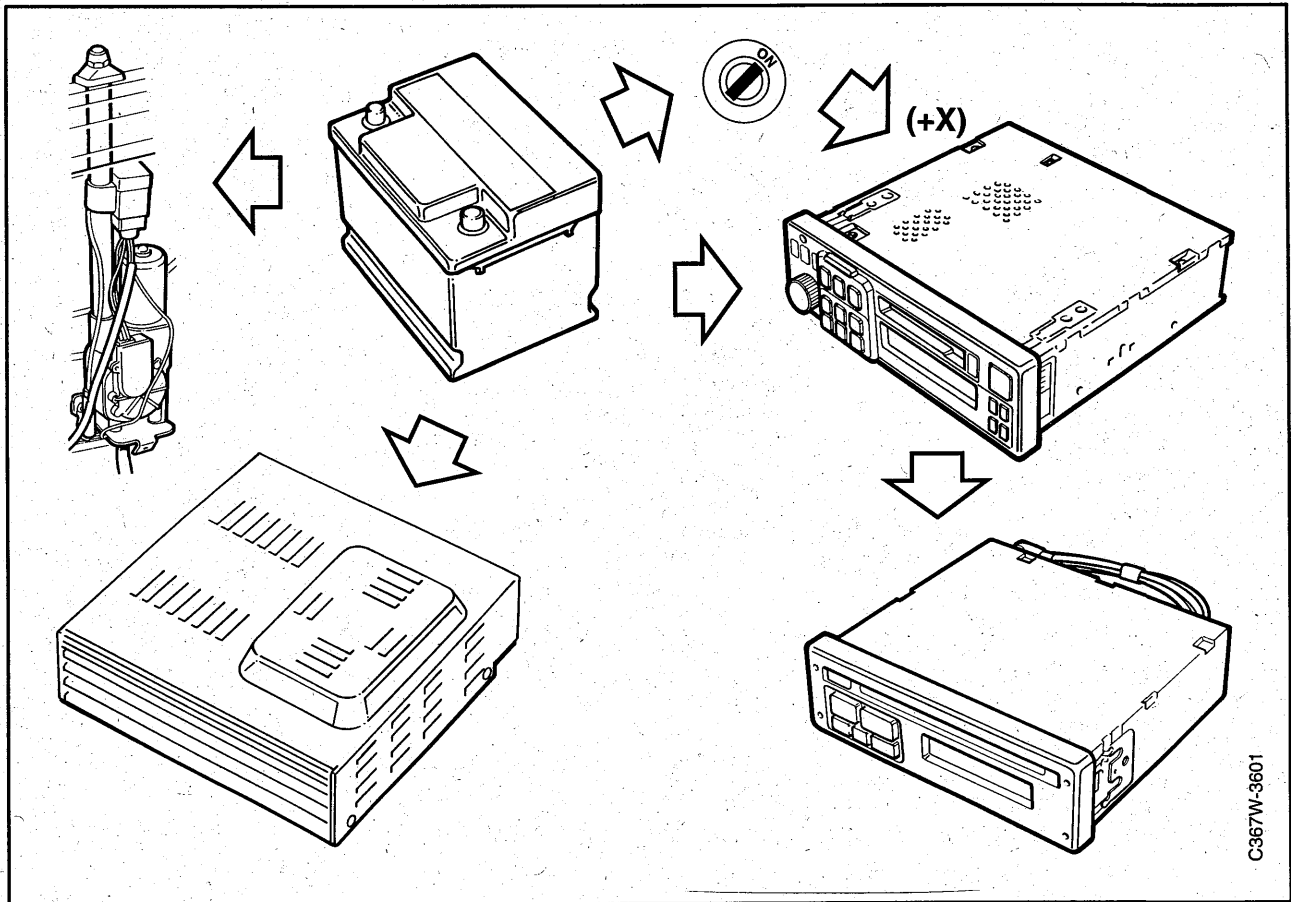

The radio and cassette unit, amplifier and the power antenna are supplied with +30 via fuse 19.

The radio and cassette unit are supplied with +X via fuse 27.

The CD player and changer is powered via the radio and cassette unit.

Grounding points

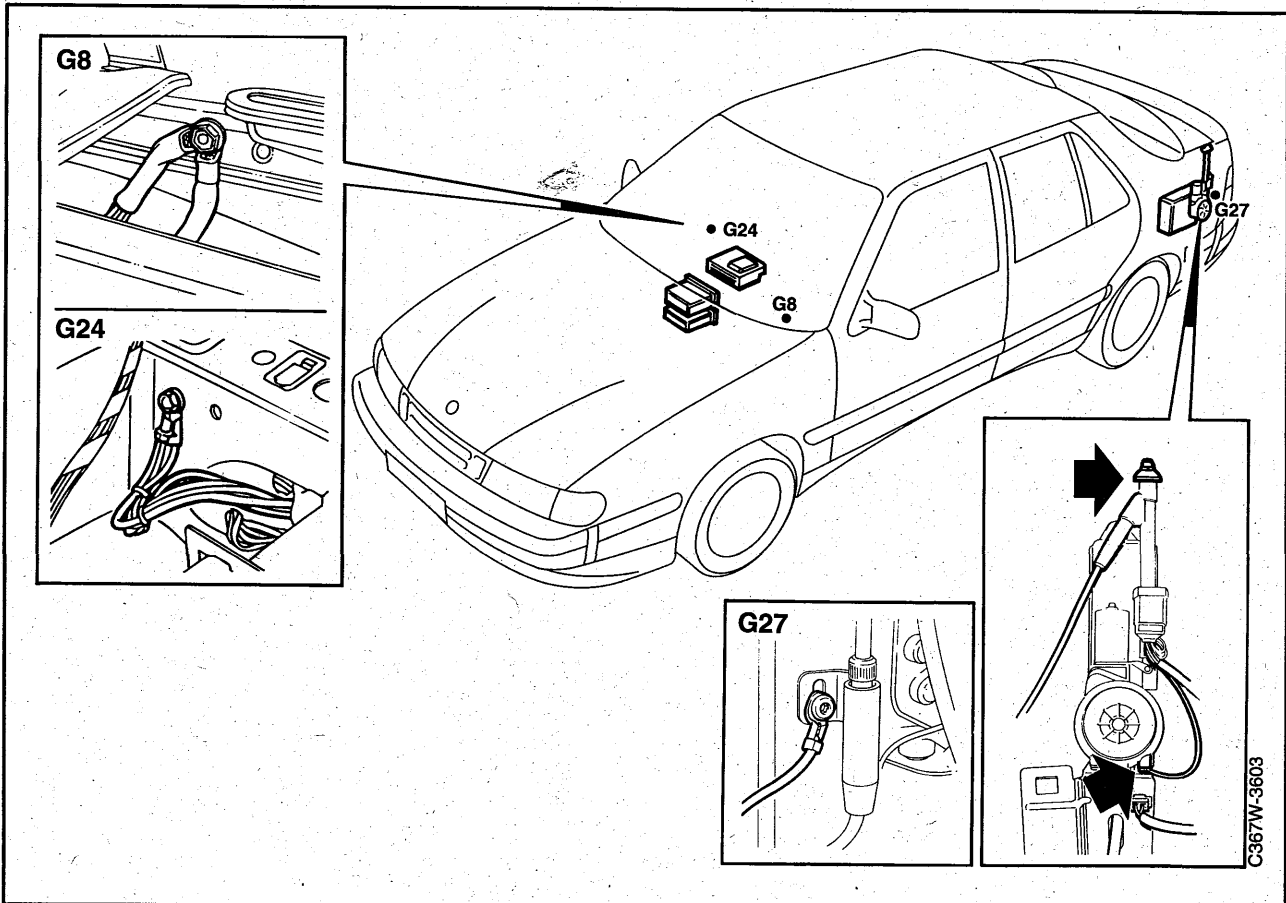

The radio and cassette unit are grounded to grounding point G8.

The amplifier is grounded to grounding point G8 (EU) or G24 (US).

The antenna is grounded via the aerial bracket to grounding point G27.

The CD player/changer is grounded via the radio and cassette unit.

Audio signal

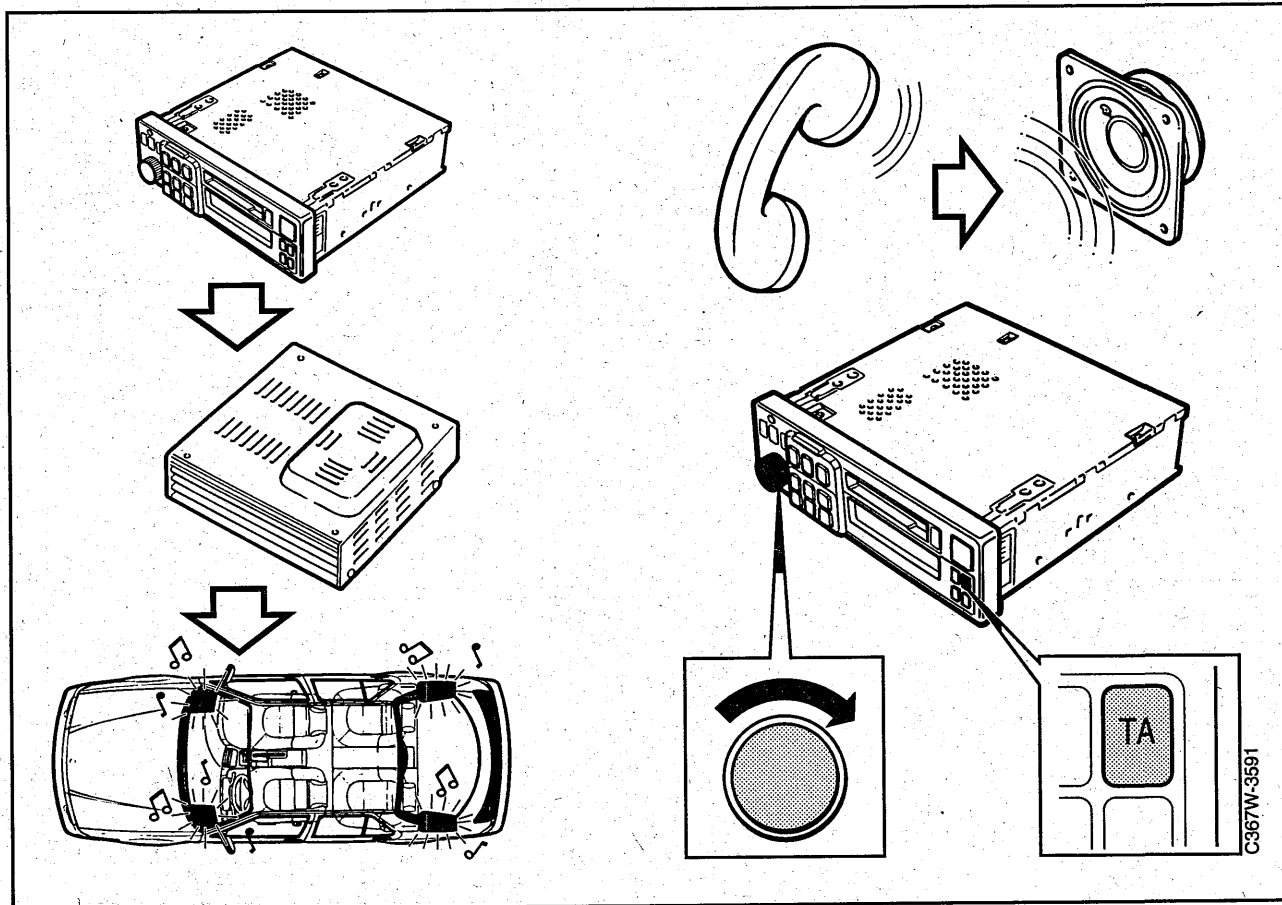

The audio signal is fed to the speakers from the amplifier located under the right-hand front seat.

Telephone controlled reduction of volume

If a mobile telephone is installed in the car, it can be connected in such a way that the volume on the radio and cassette player is reduced when the telephone is used for outgoing or incoming calls.

The mobile telephone (ground) is connected to pin 1 in connector A (gray) on the back of the radio, see page 9.

Adjustment of volume during traffic messages (EU only).

Volume can be raised when a traffic message is transmitted.

The volume is set as follows:

Press the "TA" button as the radio is switched on. ("V. ADJ" shows on the display).

Turn the volume button to required volume.

Press any other button or wait six seconds to lock the volume at the level set.

Connections to radio and cassette player

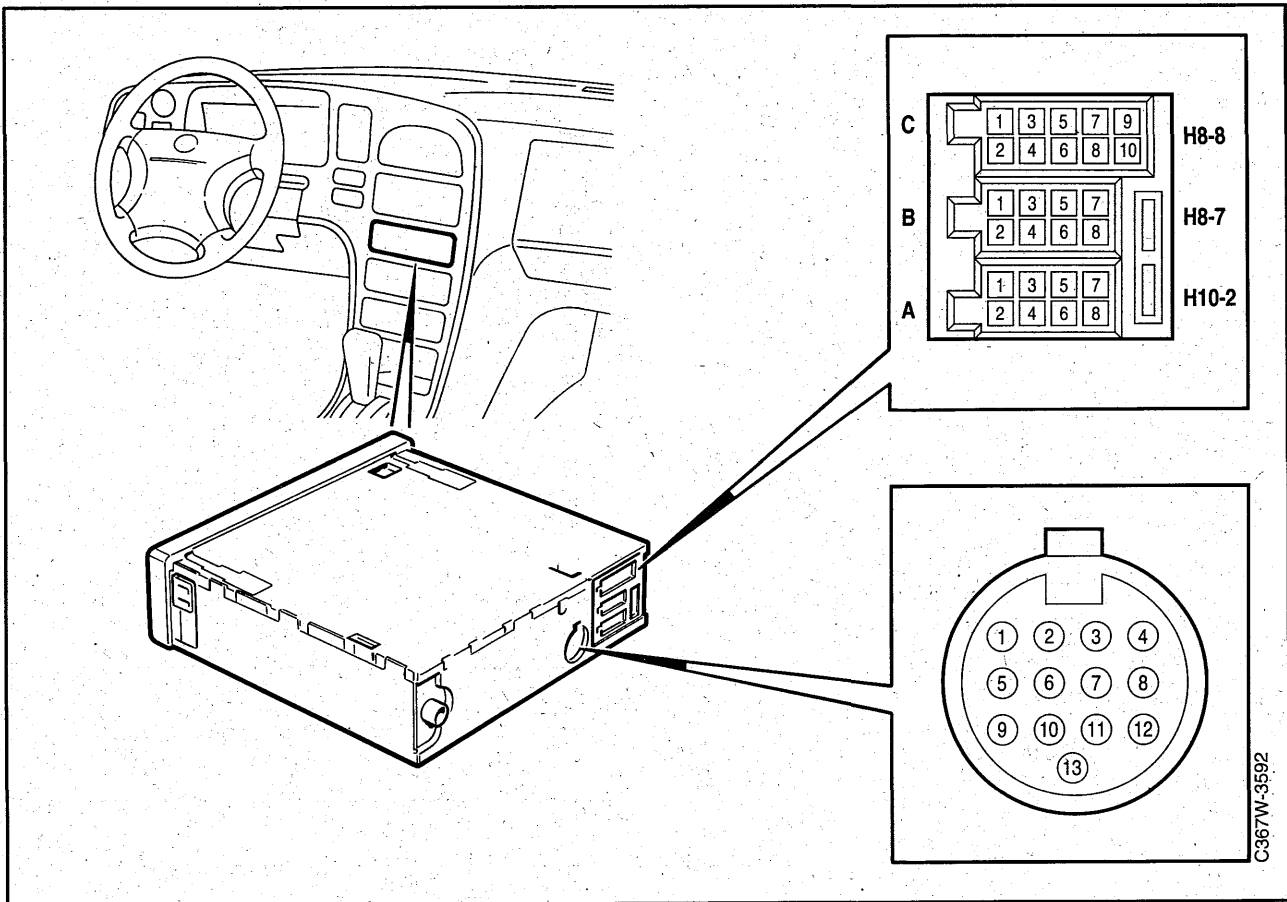

C367W-3592

Pin	Connector A
1	Telephone mute (ground)
2	Amplifier switch
3	Dimmer for display lighting
4	+30
5	Power antenna
6	Rheostat for button lighting
7	+X
8	Ground

Pin	Connector B
1	Lighting +
2	Lighting -
3	-
4	-
5	-
6	-
7	Ground
8	Dimmer for display lighting

Pin	Connector C
1	Right rear speaker +
2	Right rear speaker -
3	Right front speaker +
4	Right front speaker -
5	Left front speaker +
6	Left front speaker -
7	Left rear speaker +
8	Left rear speaker -
9	-
10	Amplifier switch

Pin	Connector for CD
1	So (Clarion data bus)
2	Sck (Clarion data bus)
3	-
4	Srq (Clarion data bus)
5	Remote
6	Signal ground
7	L ch in
8	R ch in
9	Aux in
10	Back-up
11	Acc cont
12	Ground
13	Aux out

Amplifier connectors, Audio System Premium

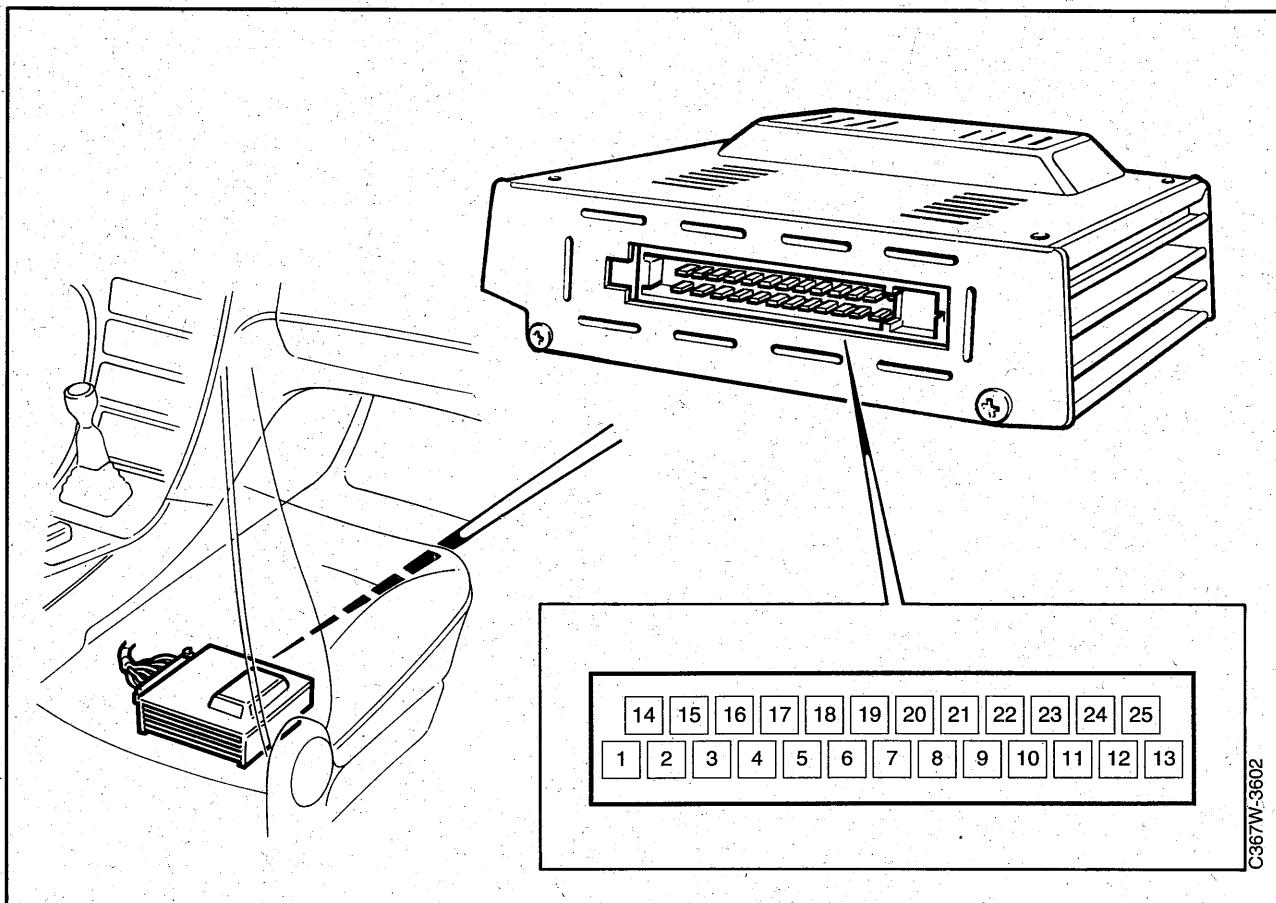

C367W-3602

Pin	Function
1	Right front in-
2	Left front in-
3	Right rear in-
4	Left rear in-
5	On / off
6	Ground -
7	+30
8	Right front speaker -
9	Left front speaker -
10	-
11	-
12	Right rear speaker -
13	Left rear speaker -

Pin	Function
14	Right front in+
15	Left front in+
16	Right rear in+
17	Left rear in+
18	Ground -
19	+30
20	Right front speaker +
21	Left front speaker +
22	-
23	-
24	Right rear speaker +
25	Left rear speaker +

Connectors on amplifier, Audio System Prestige

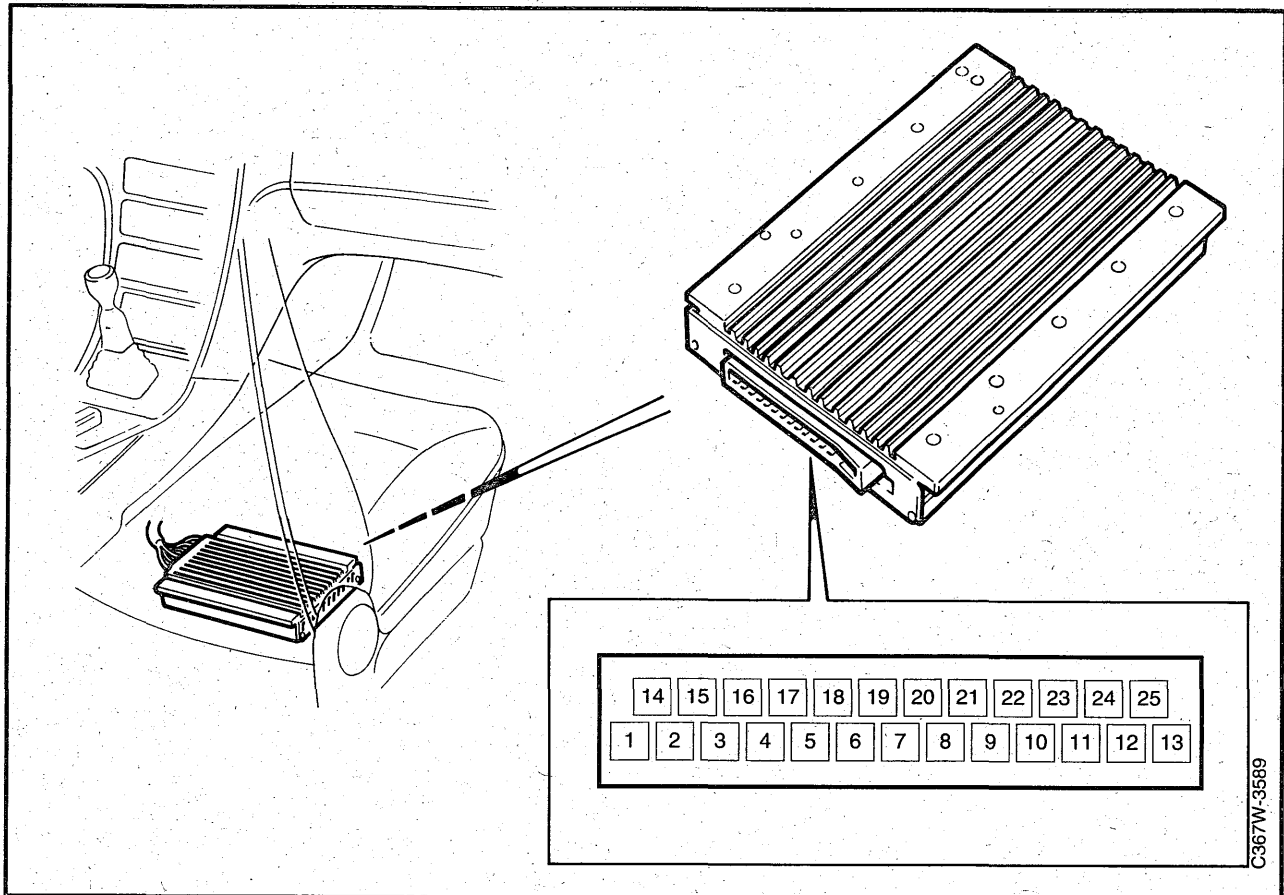

Pin	Function	
1	Right front	in-
2	Left front	in-
3	Right rear	in-
4	Left rear	in-
5	On / off	
6	Ground	-
7	+30	
8	Right front speaker	-
9	Left front speaker	-
10	Right rear woofer	-
11	Left rear woofer	-
12	Right rear speaker	-
13	Left rear speaker	-

Pin	Function	
14	Right front	in+
15	Left front	in+
16	Right rear	in+
17	Left rear	in+
18	Ground	-
19	+30	
20	Right front speaker	+
21	Left front speaker	+
22	Right rear woofer	+
23	Left rear woofer	+
24	Right rear speaker	+
25	Left rear speaker	+

Coding of radio and cassette player

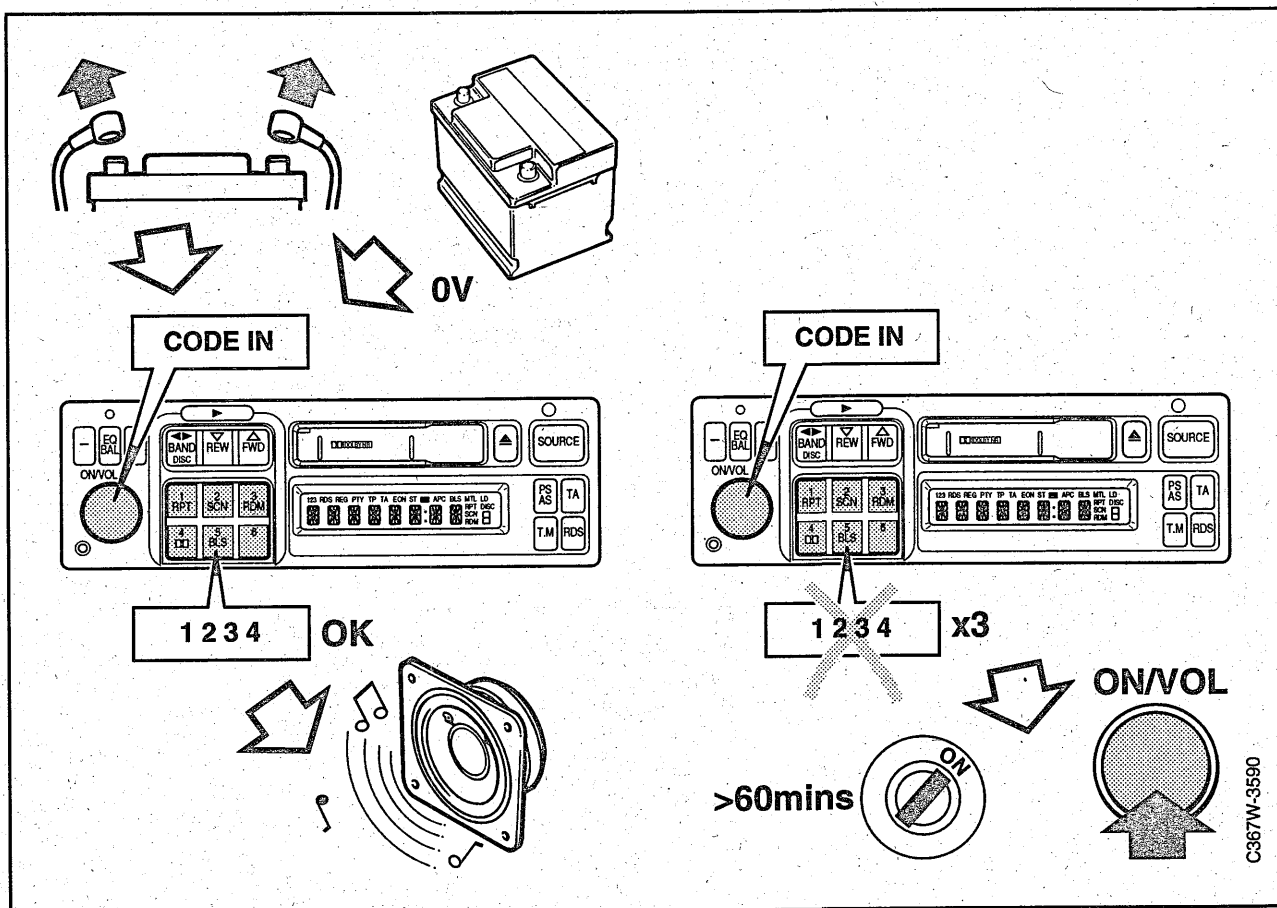

Anti-theft lock

Radio and cassette player are equipped with an electronic four-digit anti-theft lock.

The four-digit code is programmed at manufacture and cannot be changed. For this reason it is important that the code is kept in a safe place, never with the unit.

If the battery is disconnected for more than 3 minutes, if the unit is removed or if the unit for some reason is deprived of power, the four-digit code must be entered with the quick-selection buttons as follows:

- 1 Switch on the Radio (display shows "CODE IN").
- 2 Enter the four-digit code with the quick-selection buttons. If the code is correct, the last-tuned radio frequency is shown on the display.

If you have entered a wrong digit by mistake, all four digits must be entered for you to try again. If the code is wrong it stays on the display.

If an incorrect four-digit code has been entered, press the BAND button for more than three seconds to clear the display.

The display again shows "CODE IN" and a new attempt to enter the correct code can be made.

- 3 If the wrong code has been used three times in succession, four dashes appear on the display. In this case you have to wait 60 minutes with the unit switched on before trying again.

In order to try again, hold the "BAND" button depressed for at least three seconds.

"CODE IN" appears on the display.

The correct code must be entered at the first attempt, otherwise you have to wait for a further 60 minutes with the unit switched on before a new attempt can be made.

Test functions in the RDS system

(EU only).

The following test functions are available on condition that the set station transmits in RDS, and that the RDS function is activated:

- 1 Displaying current PI code:
Press "RDS" + "1" = displayed for 5 seconds.
- 2 Displaying PTY code:
Press "RDS" + "3" = displayed for 5 seconds.
- 3 Displaying current frequency or station name:
Press "RDS" + "4" = displayed for 5 seconds.
- 4 Continuous display of current frequency:
Press "RDS" + "5"

Fault diagnosis

To remember when diagnosing fault 15
Diagnostic trouble codes 16

Fault diagnosis without trouble codes 16
Speaker coil resistance 17

To remember when diagnosing fault

It is not possible to give general rules for fault diagnosis in each individual case.

Depending on the fault symptom and other information available, a certain method might be best in one situation and less suitable in another. The following points, however, can act as a guide when diagnosing faults in the Audio System.

- 1 Check fuses 19 and 27.
- 2 Check the 3A fuse on the back of the radio.
- 3 Check connectors for oxidized, displaced or badly crimped pins and gaps or anything else that may cause a bad contact.
- 4 Check that the load supply voltages and ground connections are correct.
- 5 Connectors should generally be dismantled and assembled with the ignition in the OFF position. Resistance measurement should also take-place with the ignition in the OFF position.

Diagnostic trouble codes

The Audio System automatically senses certain types of fault that can arise. These are shown on the display as diagnostic trouble codes.

Diagnostic trouble code	Fault symptom	See page
TAPE ER8	Cassette will not eject.	18
TUN ER99	Fault in radio RDS function.	18
CDAC ER1	CD changer internal battery dead.	19
CDAC ER2	Mechanical fault in CD changer.	19
CDAC ER3	Disc fault.	20
CDAC ER5	Wrong type of disc in the CD changer.	20
CDAC ER6	Disc wrong way up.	21

Fault diagnosis without trouble codes

Action No.	Fault symptom	See page
1	No sound at all. Radio display not lit. (No power.)	22
2	No sound at all. Radio display not lit. (No ground connection.)	23
3	No sound at all. Radio display lit.	24
4	No sound from one of the speakers.	25
5	Distorted or noisy sound from radio. Cassette player functioning normally. Antenna does not go up.	26
6	Crackling or scraping sound, loud clicking.	27
7	Nothing happens when any CD button on radio unit is activated.	28

Speaker coil resistance

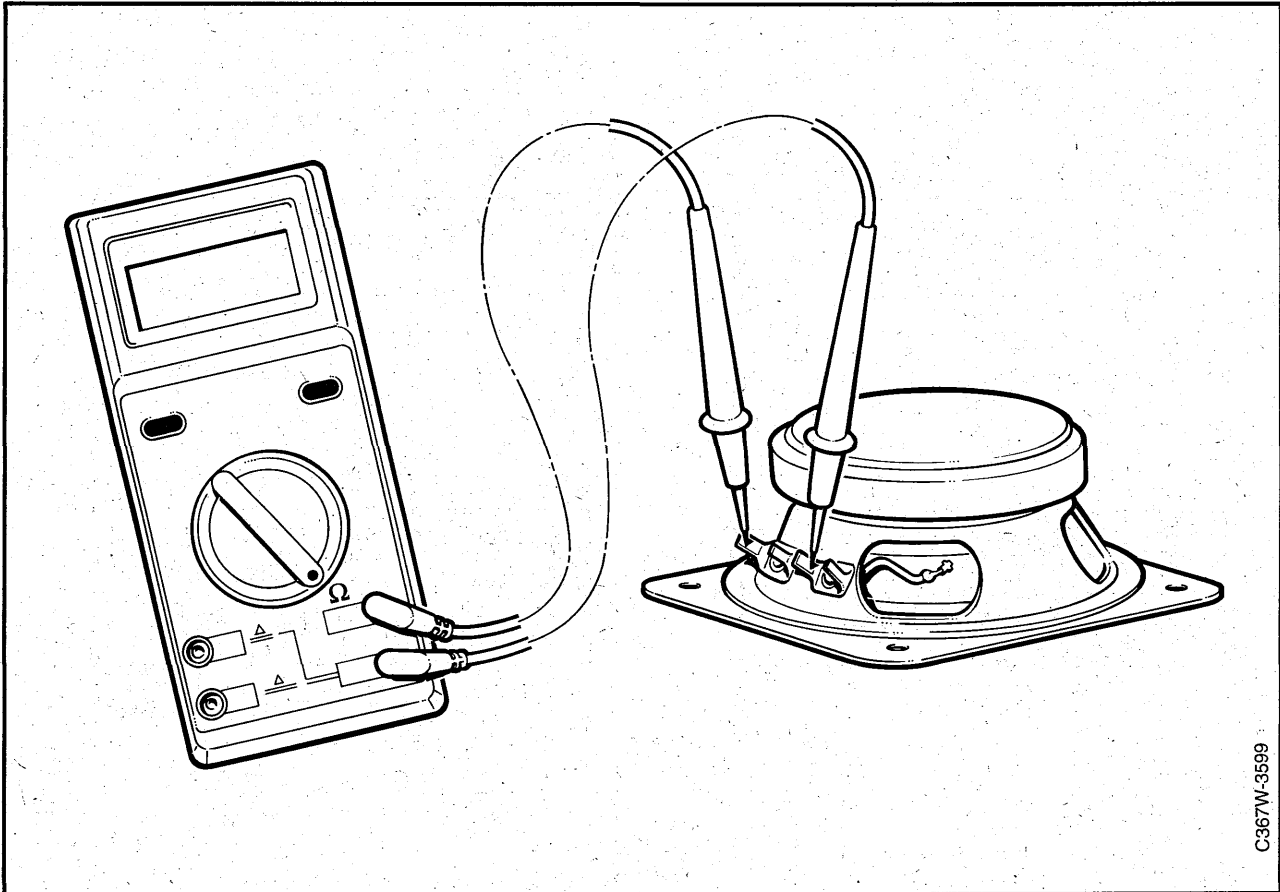

C367W-3599

Coil resistance is measured between the speaker connector pins with connectors, filters and capacitors removed.

Audio System Premium

Speaker		Measurement result
Front	mid-range	3 – 4.5 ohm
	treble	5 – 7 ohm
Rear	bass	3 – 4.5 ohm
	treble	3 – 4.5 ohm

Audio System Prestige

Speaker		Measurement result
Front	mid-range	3 – 4.5 ohm
	treble	3 – 4.5 ohm
Rear	bass	2 – 3 ohm
	mid-range	3 – 4.5 ohm
	treble	3 – 4.5 ohm

Diagnostic trouble code TAPE ER8 and TUN ER99

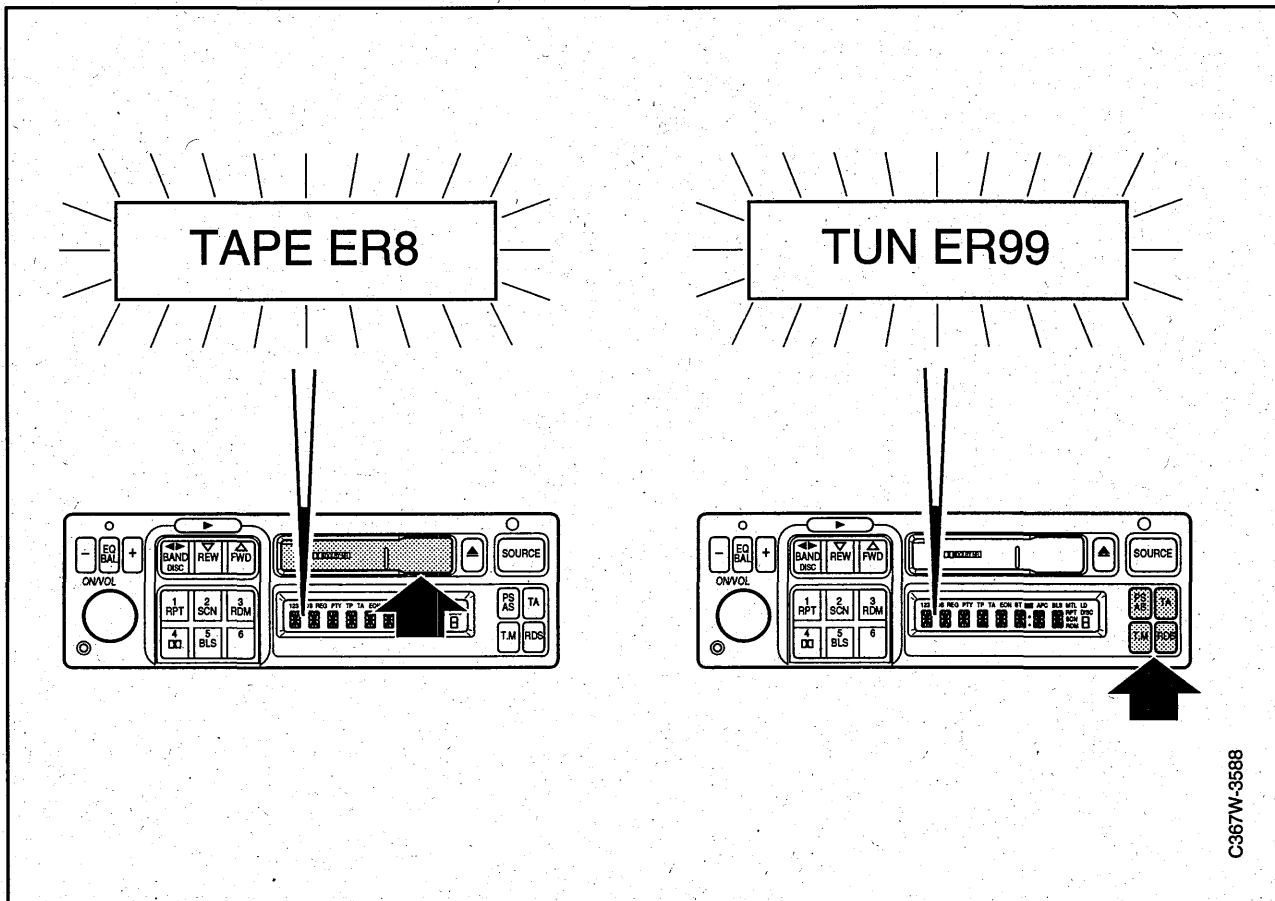

Fault symptom for TAPE ER8

Cassette will not eject.

Action

Check that no foreign bodies have been inserted through the cassette door.
Remove any foreign bodies.
If no foreign bodies can be seen through the door, continue with "Replacing Components" on page 29.

Fault symptom for TUN ER99

Fault in radio RDS function.

Action

Continue with "Replacing Components" on page 29.

Diagnostic trouble code CDAC ER1 and CDAC ER2

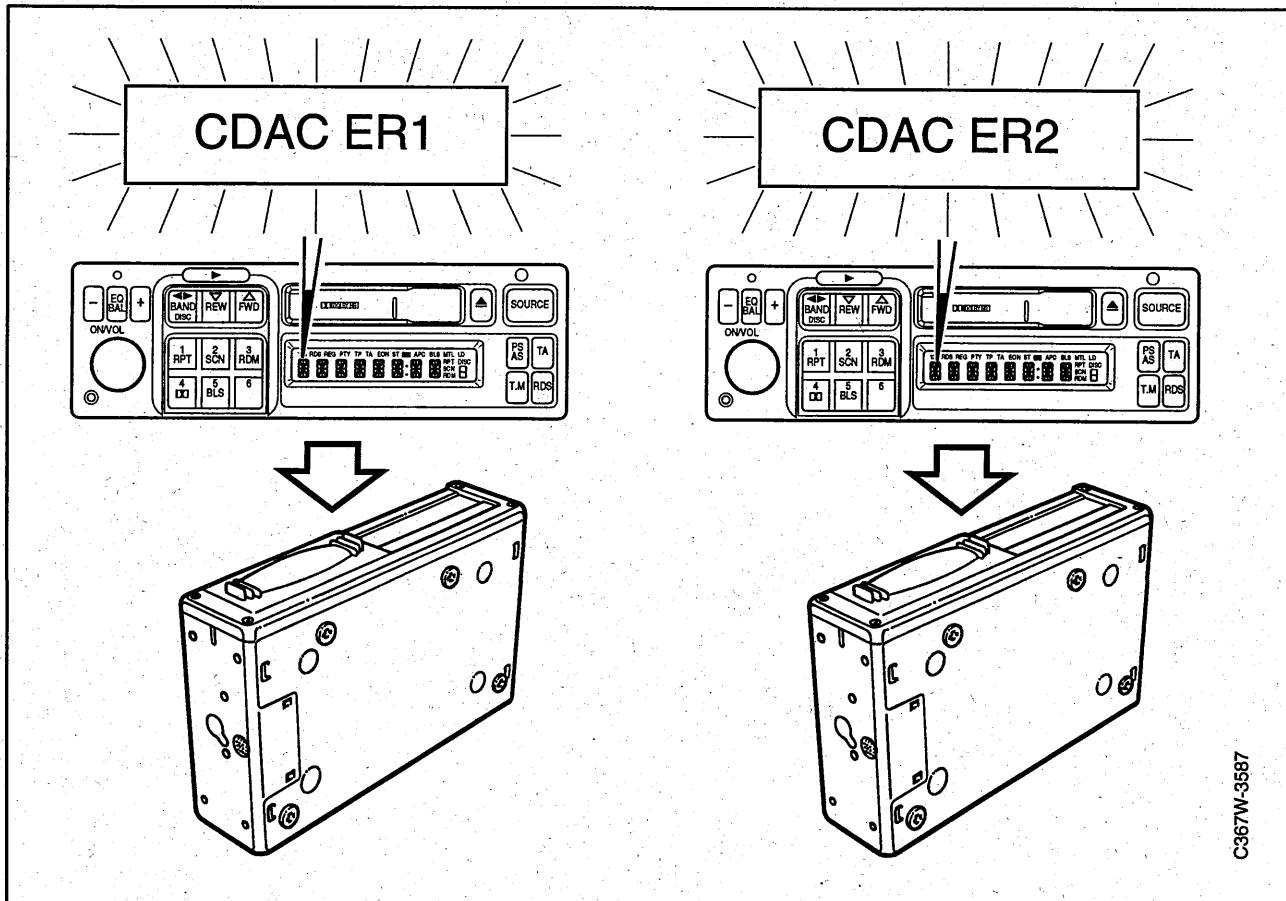

Fault symptom for CDAC ER1

CD changer internal battery dead.

Action

Continue with "Replacing Components" on page 29.

Fault symptom for CDAC ER2

Mechanical fault in CD changer.

Action

Continue with "Replacing Components" on page 29.

Diagnostic trouble codes CDAC ER3 and CDAC ER5

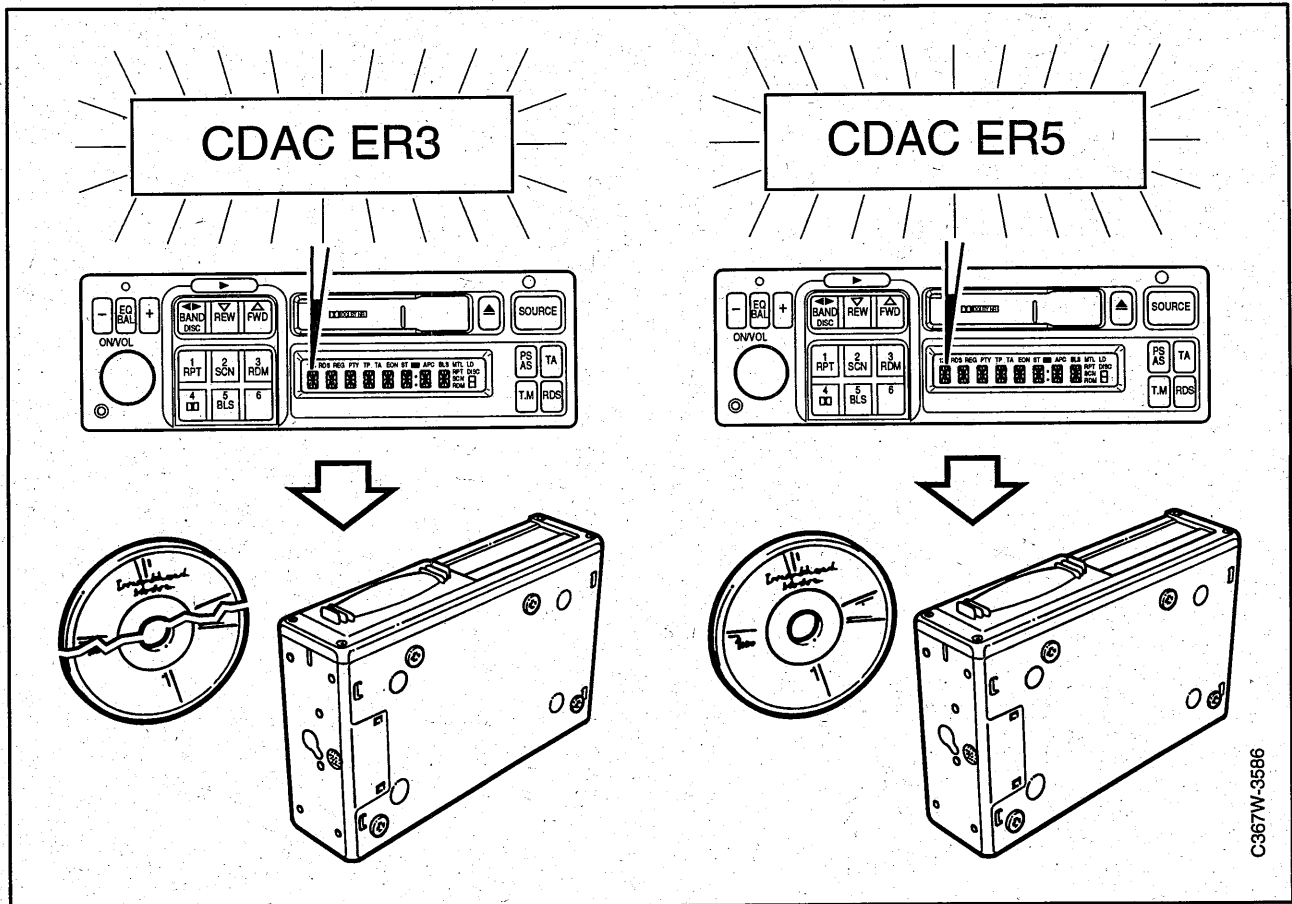

C367W-3586

Fault symptom for CDAC ER3

This trouble code appears when there is a fault with the disc.

Action

Change disc.

Fault symptom for CDAC ER5

This trouble code is displayed when, for example, you have put in a CD ROM disc instead of a CD disc.

Action

Remove the CD ROM disc and insert a CD disc.

Diagnostic trouble code CDAC ER6

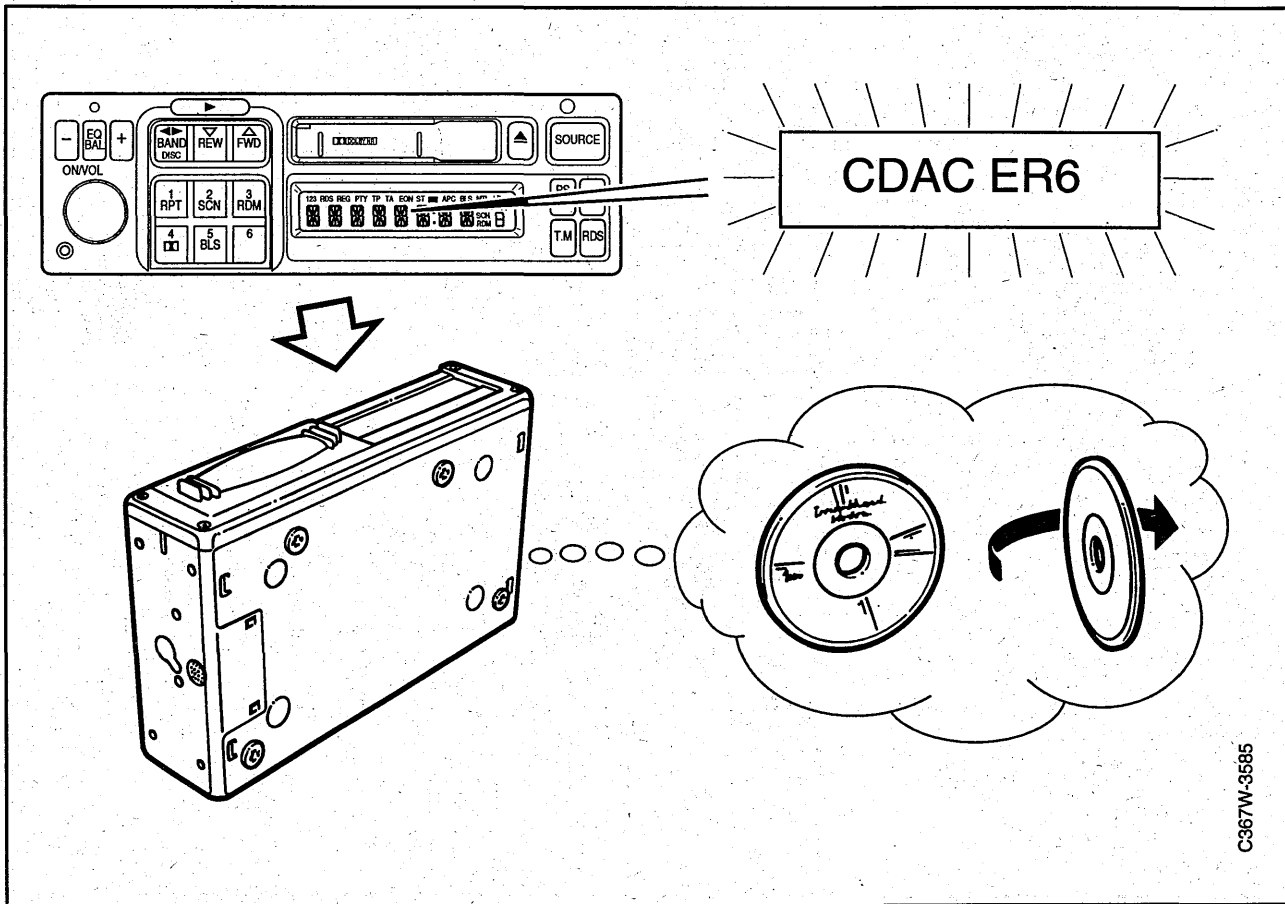

C367W-3585

Fault symptom

This trouble code is displayed if the CD disc is the wrong way up, or if there is no disc in the CD single adaptor.

Action

Turn the disc or remove the CD single adaptor.

Action 1

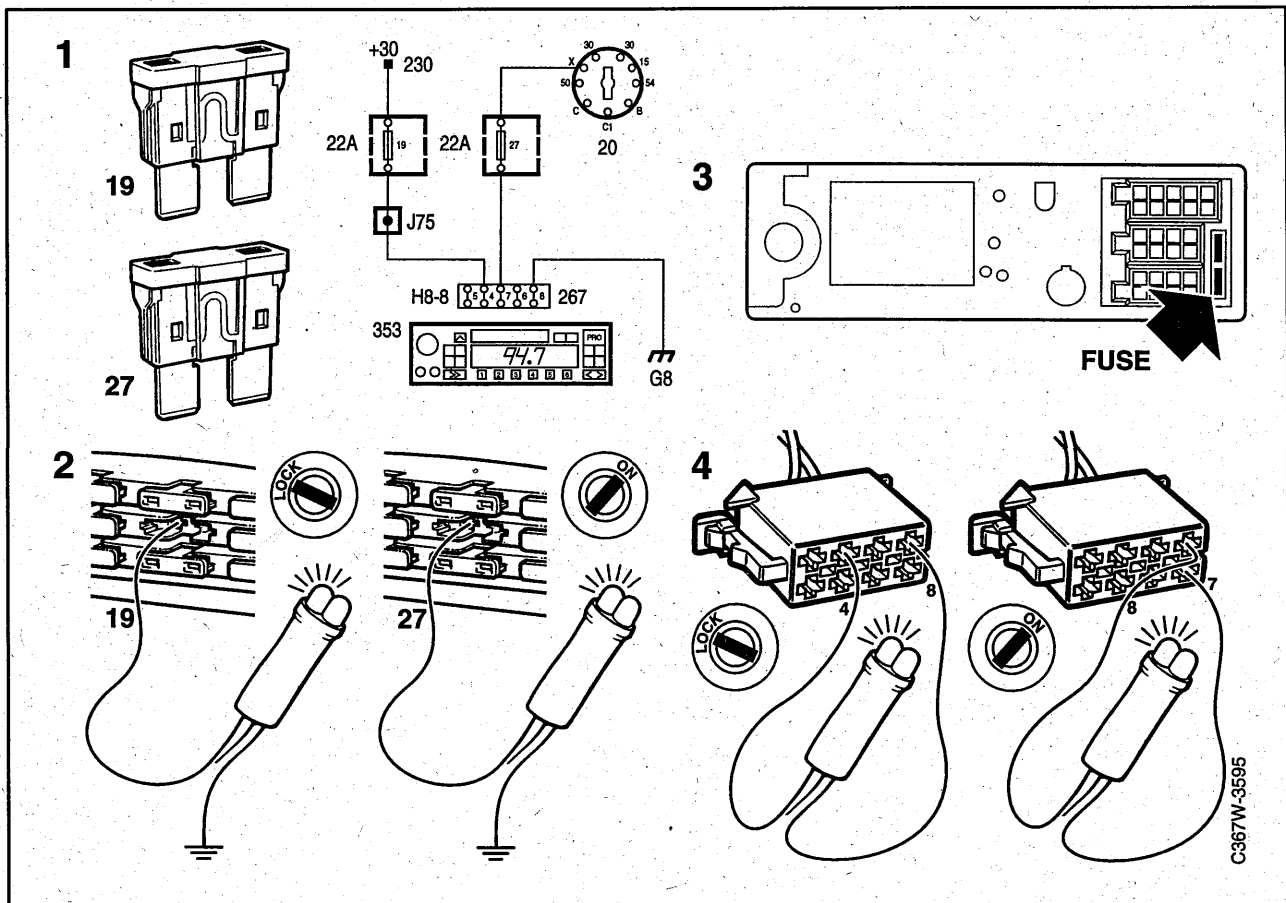
**Fault symptom**

No sound at all.
Radio display not lit.

Conditions

No power.

Action

- 1 Check fuses 19 and 27.
- 2 Check voltage to the fuses.
With the ignition in the OFF position, connect a test lamp between fuse 19 and a safe grounding point.
Then, with the ignition in the ON position, connect a test lamp between fuse 27 and a safe grounding point.
The test lamp should light in both cases.
If there is no voltage to fuses 19 and 27, continue with the fault diagnosis in Service Manual "3:2 Electrical System".
- 3 Check the 3A fuse on the back of the radio.
- 4 Check voltage to the radio unit.
Unplug connector A (gray) on the back of the radio and, with the ignition in the OFF position, connect the test lamp between pin 4 and pin 8.

Then, with the ignition in the ON position, connect the test lamp between pin 7 and pin 8. The test lamp should light in both cases. If the test lamp does not light, check the following wires for break or short -circuit:
Connector A, pin 4 to fuse 19.
Connector A, pin 7 to fuse 27.

- 5 Continue with "Replacing Components" on page 29.

Action 2

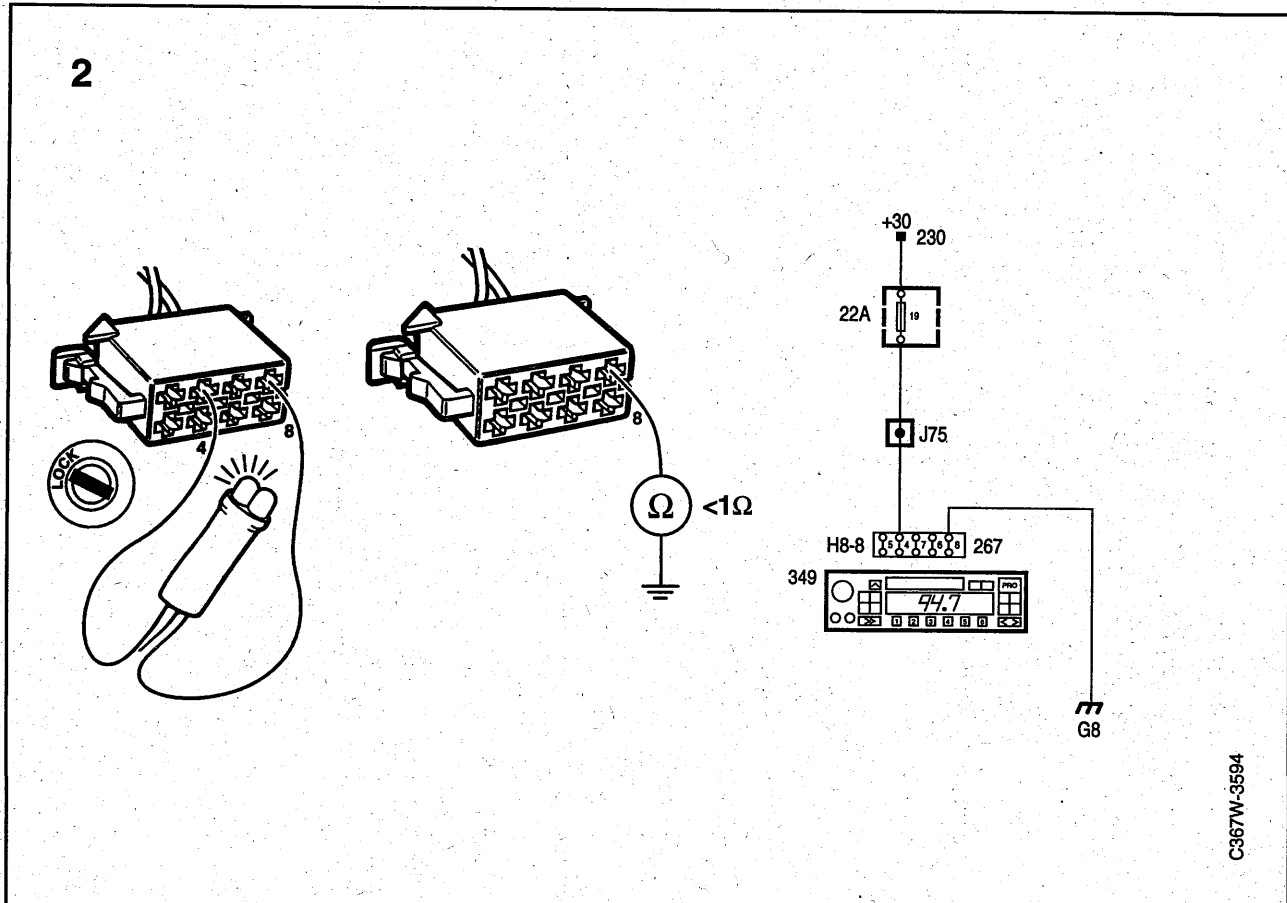

Fault symptom

No sound at all.
Radio display does not light.

Conditions

No ground connection.

Action

- 1 Look at grounding point G8.
If there is any doubt about the quality of the grounding point, remove the bolts and clean the contact surfaces.
Replace the cable shoe and bolt.
- 2 Check the radio ground connection.
Unplug connector A (gray) on the back of the radio. Connect a test lamp between pin 4 and pin 8. The test lamp should light.
If the test lamp does not light, check the wire between pin 8 in connector A and grounding point G8 for breaks.
- 3 Continue with "Replacing Components" on page 29.

Action 3

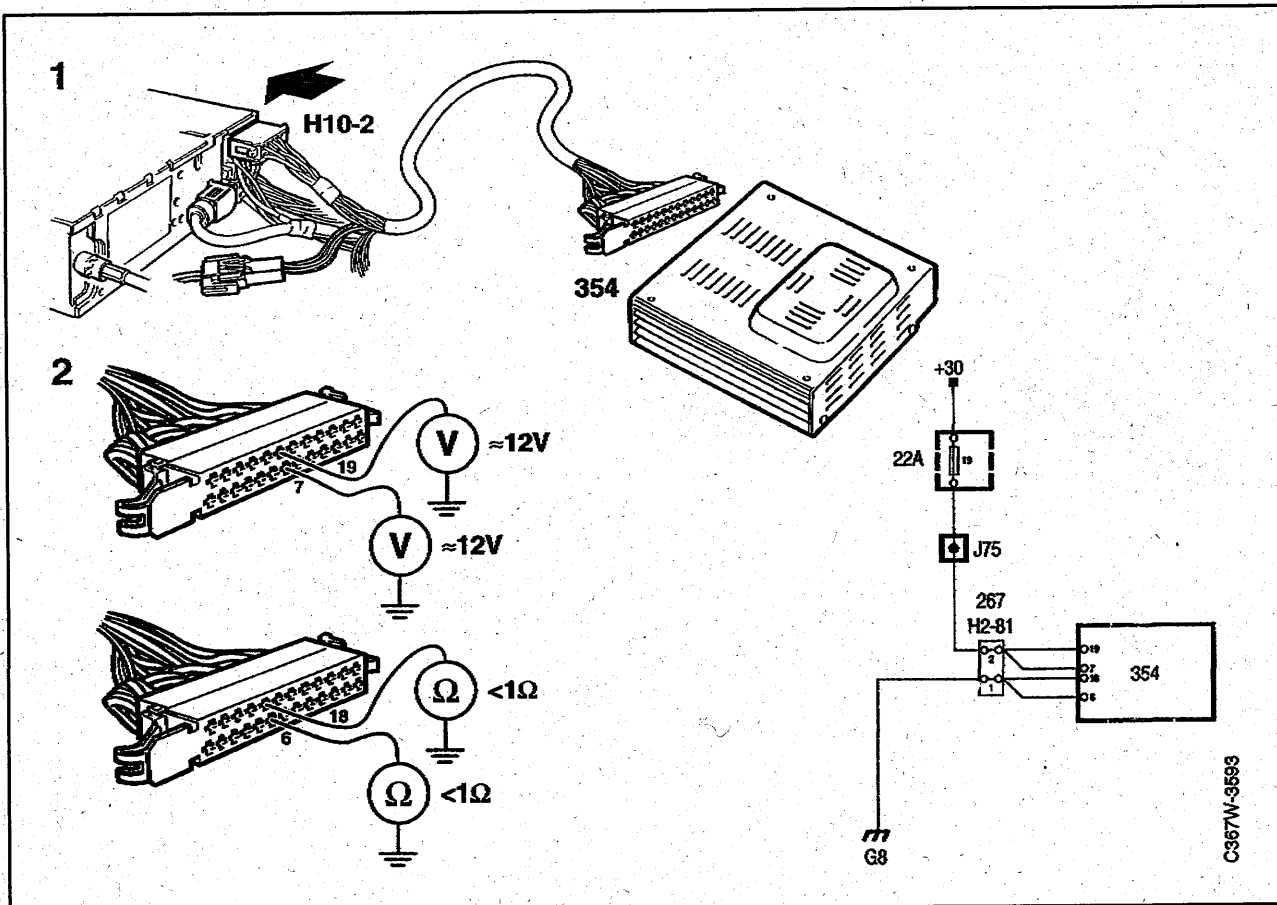

Fault symptom

No sound at all.
The radio display does not light.

Conditions

No power or ground connection to the amplifier.
Break/short-circuit in the wiring between the radio and the amplifier.

Action

- 1 Unplug the 25-pin connector from the amplifier. Check the voltage supply by connecting a test lamp between pin 7 in the connector and a safe grounding point. Also connect the test lamp between pin 19 and a safe grounding point. The test lamp should light in both cases. If the test lamp does not light, check the following wires for breaks:
25-pin connector, pin 7 to fuse 19.
25-pin connector, pin 19 to fuse 19.
- 2 Check the ground connection by connecting a test lamp between pin 6 and pin 7 in the 25-pin connector. Also connect the test lamp between pins 18 and 19. The test lamp should light in both cases.

If the test lamp does not light, check the following wires for breaks:

25-pin connector, pin 6 to grounding point G8.
25-pin connector, pin 18 to grounding point G8.

- 3 Check the wiring between radio unit and amplifier. Unplug connector C (orange) on the back of the radio unit. Conduct continuity test on wires between connector C and the 25-pin connector.
- 4 Continue with "Replacing Components" on page 29.

Action 4

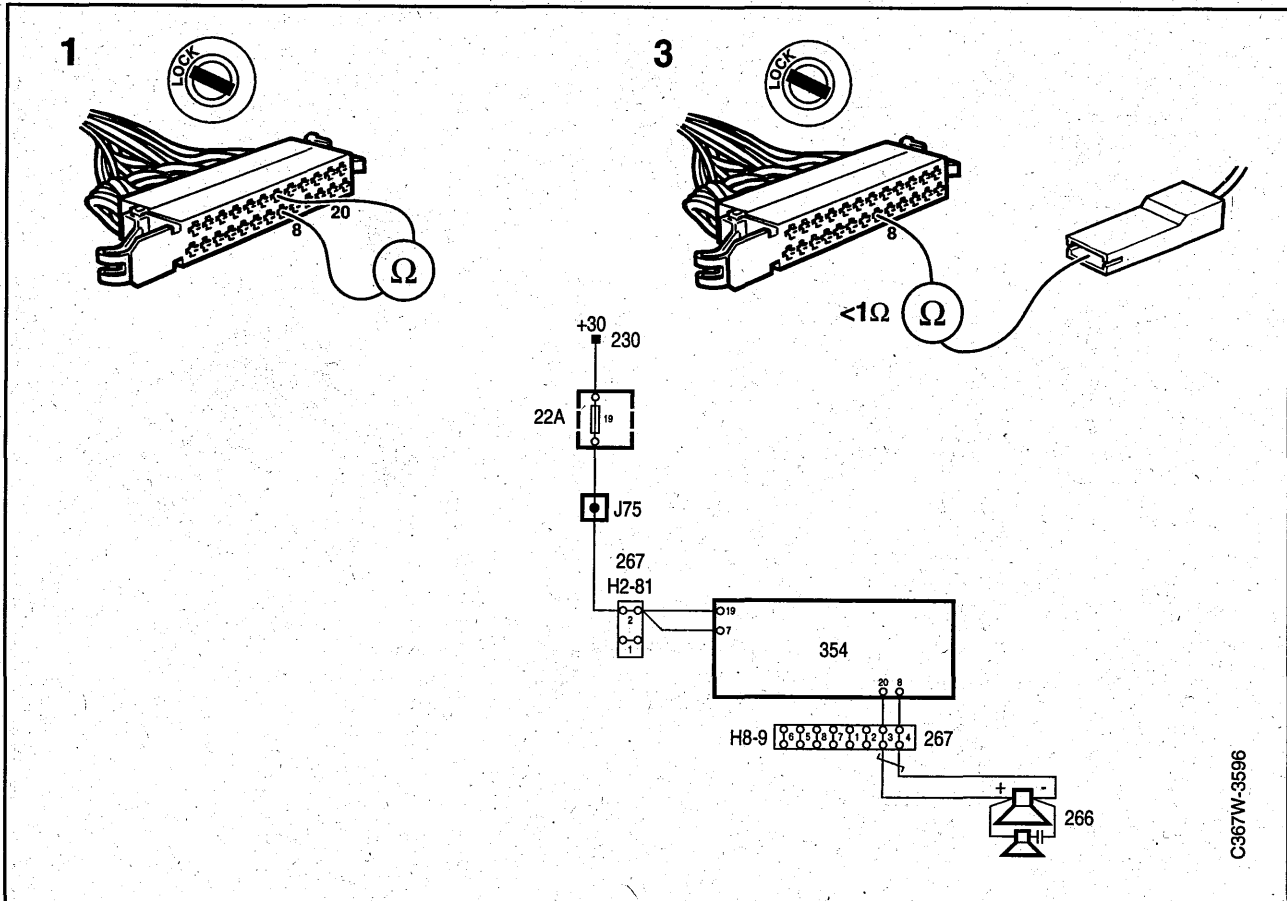

C367W-5596

Fault symptom

No sound from one of the speakers.

Conditions

Break in the speaker circuit or break in the wiring between the radio unit and the amplifier.

Action

- 1 Unplug the 25-pin connector from the amplifier. Check the resistance of the speaker in question by taking an ohm measurement in the connector, see adjacent table. (The resistance should be 3–5 ohms.) If the test gives an incorrect value, continue with point 2.
- 2 Measure coil resistance, see page 17. If the test gives a correct value, continue with point 3. If the test gives an incorrect value, continue with "Replacing Components" on page 29.
- 3 Check the wiring for the speaker in question. Conduct continuity test between the speaker connector pin and the corresponding pin in the 25-pin connector.
- 4 Check the wiring between the radio unit and the amplifier.

Speaker	Pin in 25-pin connector	Pin on speaker
RF +	20	2
RF -	8	1
LF+	21	2
LF-	9	1
RR+	24	2
RR-	12	1
LR+	25	2
LR-	13	1
*RR bass+	22	2
*RR bass-	10	1
*LR bass+	23	2
*LR bass-	11	1

*Audio System Prestige only.

Action 5

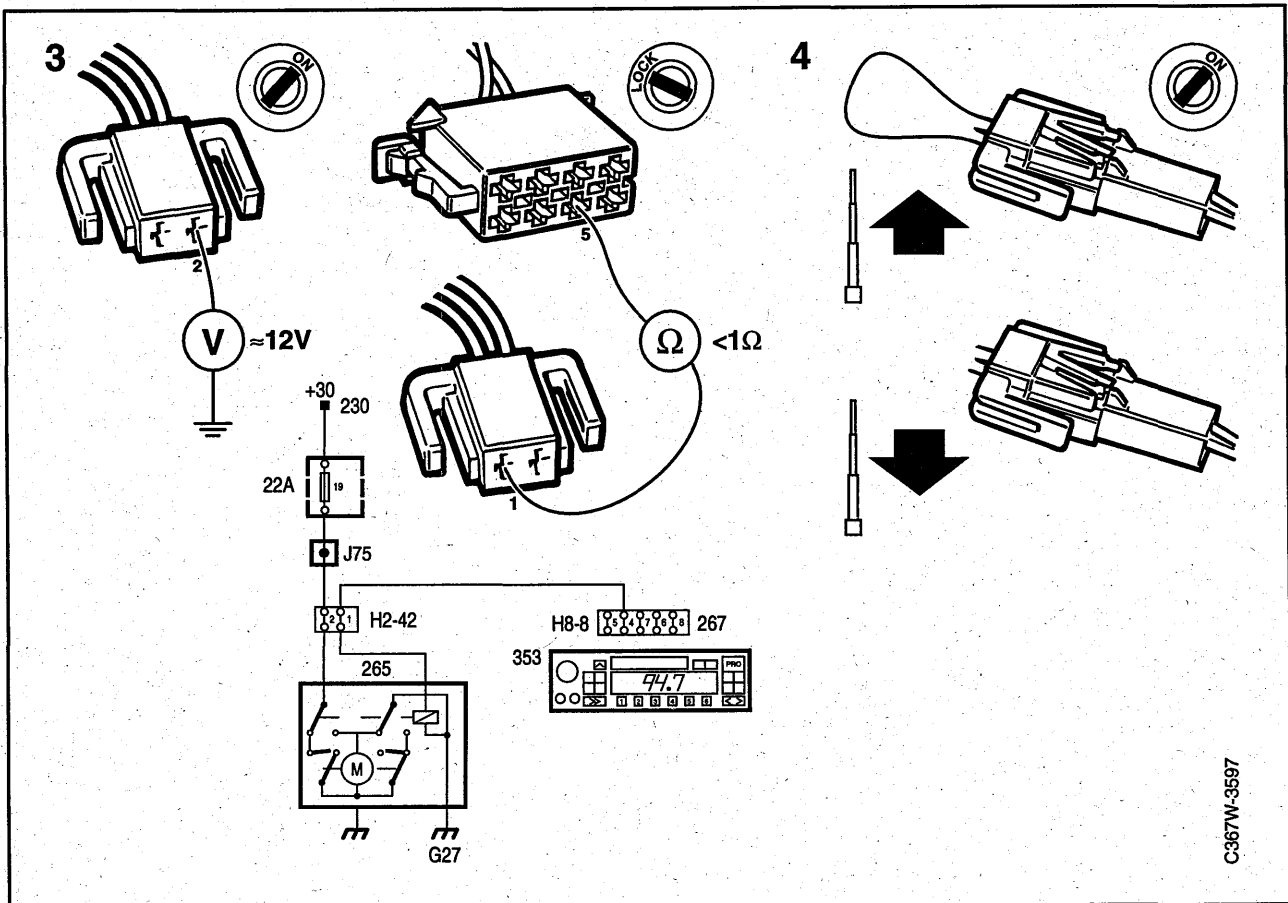

Fault symptom

Distorted or noisy sound on the radio.
Cassette player functioning normally.
Antenna does not go up.

Conditions

Fault in the antenna motor control circuit.

Action

- 1 Check fuse 19.
- 2 Check voltage to fuse 19.
Connect a test lamp between fuse 19 and a safe grounding point. The test lamp should light.
No voltage to fuse 19, continue with fault diagnosis in Service Manual "3:2. Electrical System".
- 3 Check power to motor circuit.
Unplug power antenna connector H2-42, and connect the test lamp in the female connector between pin 2 and a safe grounding point.
Then, with the radio switched on, connect the test lamp between pin 1 in the female connector and a safe grounding point.
The test lamp should light.
If the test lamp does not light, check the following wires for breaks:

H2-42, pin 2 to fuse 19.

H2-42, pin 1 to connector A, pin 5.

If there is no fault in the wire, continue with "Replacing Components" on page 29.

- 4 Connect connector H2-42.
Check the motor circuit by strapping between pin 1 and pin 2 on the reverse of the female connector.
Connected strap should make the antenna go up.
When the strap is released the antenna should go down.
If the antenna does not work, check grounding point G27.
If the grounding point is intact, continue with "Replacing Components" on page 29.

C367W-3597

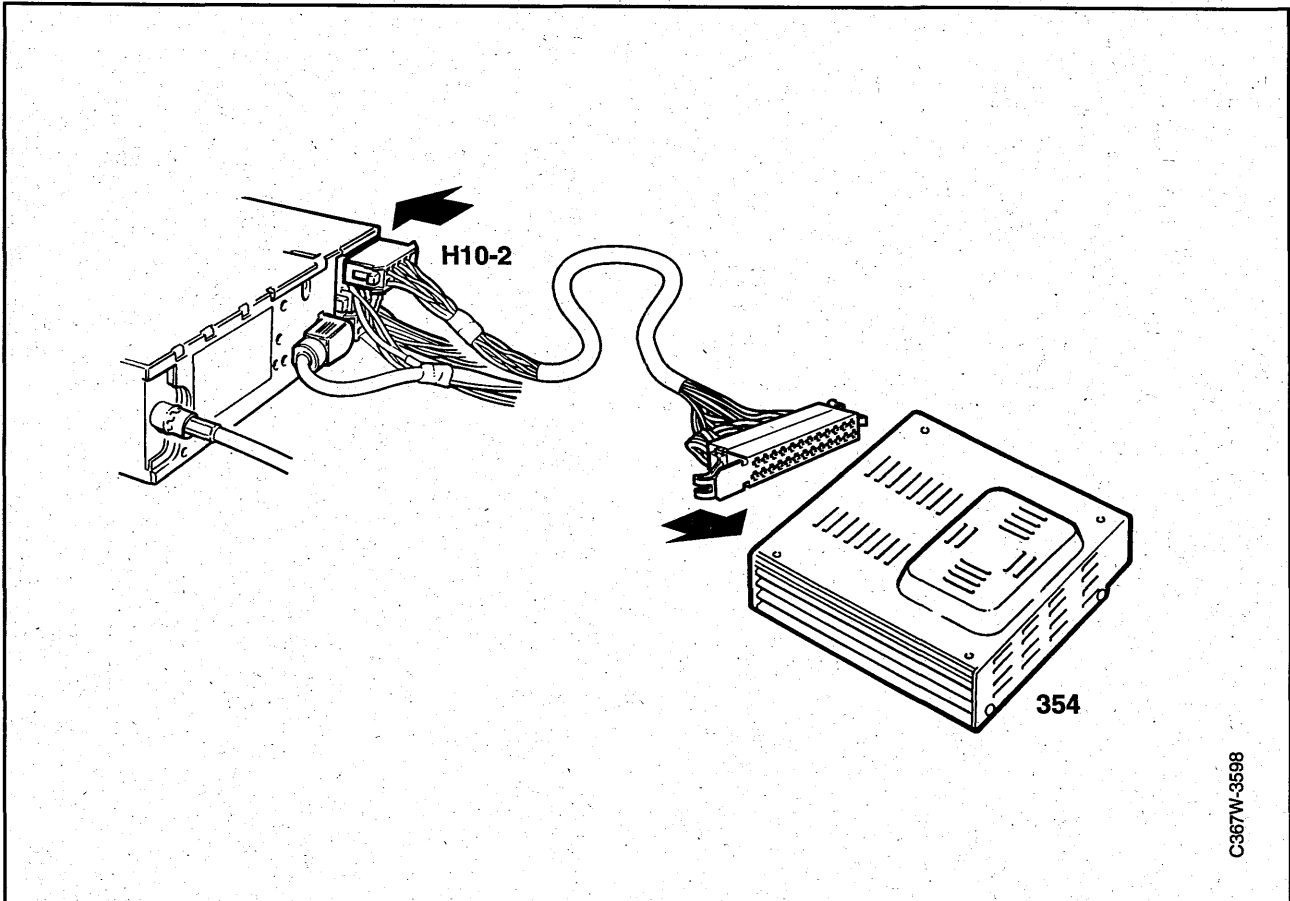
Action 6

C367W-3598

Fault symptom

Crackling or scraping sound, loud popping.

Conditions

Poorly connected wiring between the radio unit and the amplifier.

Action

Check that the wiring is properly connected to both the radio unit and the amplifier.

Action 7

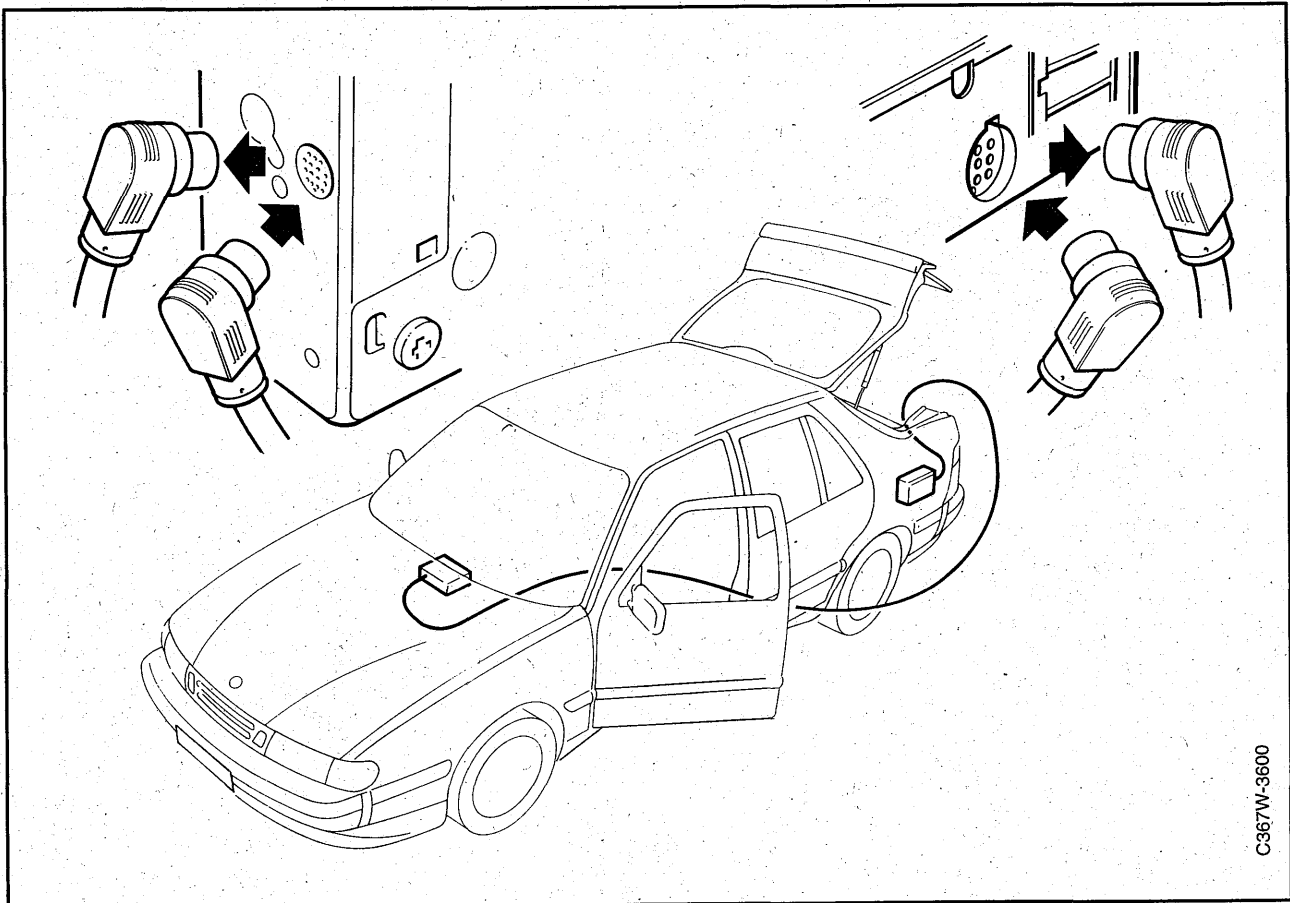

C367W-3600

Fault symptom

Nothing happens when one of the CD buttons on the radio unit is activated.

Conditions

CD changer faulty.

Action

- 1 If the CD changer is not functioning and no fault codes for the CD changer are displayed, check that the DIN cable is properly connected.
- 2 Disconnect the cable at both ends and try a new cable, but before fitting it wait until you are sure that the old cable was the cause of the problem.
- 3 If it works with a new cable, change the old one. Use the fixing points from the old cable.
- 4 If point 2 does not work, reconnect the old cable and continue with "Replacing Components" on page 29.

Replacing Components

Action before replacing radio/CD player/ amplifier	29	Prestige	36
Warranty Report	30	Rear speakers 9000 CS, Audio System	
Radio and cassette player	31	Premium	37
CD player	32	Rear speakers 9000 CS, Audio System	
Amplifier	33	Prestige	39
Front speakers	34	Power antenna 9000 CD	41
Rear speakers 9000 CD, Audio System		Power antenna 9000 CS	42
Premium	35	Antenna rod	43
Rear speakers 9000 CD, Audio System		Antenna cable	44
		Wiring between radio unit and amplifier	45

Action before replacing radio/CD player/amplifier

When all checks have been conducted as per the action program under each fault diagnosis and no fault has been detected, it is natural to assume that the radio/CD player/amplifier is faulty.

Considering that the radio/CD player/amplifier is both a very high quality and a very expensive component, it is important to ensure as far as possible that the diagnosis is correct.

Go through the following points very carefully before you definitely decide that the radio/CD player/amplifier is the cause of the fault.

- 1 Check once again that all the points in the function test or all points in the relevant fault diagnosis diagram have been followed.
- 2 Study the circuit diagram of the circuit in question and make sure you know how it works. If necessary use the appropriate parts of the technical description and the electrical operation description in Service Manual 3:2 Electrical Systems.
- 3 Check all grounding points. If you have done this before, do it again.
- 4 Check the power supply and the fuses for the radio/CD player/amplifier.
- 5 Check that there are no slide-outs in the component's glove.
- 6 Go through the points under "To remember when diagnosing a fault" on page 15.
- 7 If the original fault is still there despite this, the radio/CD player/amplifier must be repaired.
- 8 In markets where there is a repair system for Clarion products, faulty radios or CD players should be sent to CLARION SERVICE for repair.
Before doing this, the Warranty Report should be filled in, see page 30.

WARRANTY REPORT

IMPORTANT Any missing information on this document may result in an out-of-warranty repair and a charge will be made.

To:

.....

.....

.....

.....

Name and address of dealer:

.....

.....

.....

Dealer No:.....

Day	Month	Year	Vehicle Chassis No	Mileage
<input type="text"/>	<input type="text"/>	<input type="text"/>	<input type="text"/>	<input type="text"/>
Model	Serial No	CATS code	Stock part	
<input type="text"/>	<input type="text"/>	<input type="text"/>	<input type="text"/>	

EXTERNAL DEFECTS

- | | | |
|-------------------------------------|--|--|
| 80 <input type="checkbox"/> Housing | 60 <input type="checkbox"/> Escutcheon | 18 <input type="checkbox"/> Power switch |
| <input type="checkbox"/> Wiring | 30 <input type="checkbox"/> CD/Cassette door | 24 <input type="checkbox"/> Buttons |

DEFECTS

- | | | |
|--|--|--|
| 1 <input type="checkbox"/> Dead | 17 <input type="checkbox"/> Display | 54 <input type="checkbox"/> CATS Code System |
| 3 <input type="checkbox"/> Intermittent | 18 <input type="checkbox"/> No illumination | 24 <input type="checkbox"/> Phone interrupt |
| 4 <input type="checkbox"/> Distorted sound | 24 <input type="checkbox"/> Preset buttons | |
| <input type="checkbox"/> Defect when warm/cold | 48 <input type="checkbox"/> Motor ant. inoperative | 18 <input type="checkbox"/> Power switch |

DETAILS OF COMPLAINT

- | | | |
|---|--|--|
| <p>Radio</p> <p>6 <input type="checkbox"/> No AM/LW or FM</p> <p>7 <input type="checkbox"/> Poor AM/LW reception</p> <p>8 <input type="checkbox"/> Poor FM reception</p> <p>9 <input type="checkbox"/> Station fading</p> <p>10 <input type="checkbox"/> No separation</p> <p>13 <input type="checkbox"/> Static noise AM/LW</p> <p>14 <input type="checkbox"/> Static noise FM</p> <p>15 <input type="checkbox"/> External noise</p> <p>21 <input type="checkbox"/> Memory defective</p> <p>53 <input type="checkbox"/> Traffic info inoperative</p> <p>55 <input type="checkbox"/> RDS</p> <p>20 <input type="checkbox"/> Search or scan defective</p> <p><input type="checkbox"/> Diagnostic trouble code</p> | <p>Cassette/CD player</p> <p>1 <input type="checkbox"/> No function</p> <p>4 <input type="checkbox"/> Distorted sound</p> <p>2 <input type="checkbox"/> Right/left channel dead</p> <p>20 <input type="checkbox"/> Search or scan defect</p> <p>31 <input type="checkbox"/> Mechanism inoperative</p> <p>32 <input type="checkbox"/> No high frequency response</p> <p>34 <input type="checkbox"/> Wow and flutter</p> <p>36 <input type="checkbox"/> Auto Reverse defect</p> <p>37 <input type="checkbox"/> APC inoperative</p> <p>38 <input type="checkbox"/> Loading defective</p> <p>39 <input type="checkbox"/> Eating tape</p> <p>40 <input type="checkbox"/> Eject defective</p> <p>41 <input type="checkbox"/> FF/REW defective</p> <p>42 <input type="checkbox"/> Motor/mechn. noise</p> <p><input type="checkbox"/> Diagnostic trouble code</p> | <p>Amplifier</p> <p>1 <input type="checkbox"/> No function</p> <p>2 <input type="checkbox"/> Right/left channel dead</p> <p>3 <input type="checkbox"/> Intermittent</p> |
|---|--|--|

99 Others:

SIGNATURE:

.....

DATE:

.....

Radio and cassette player

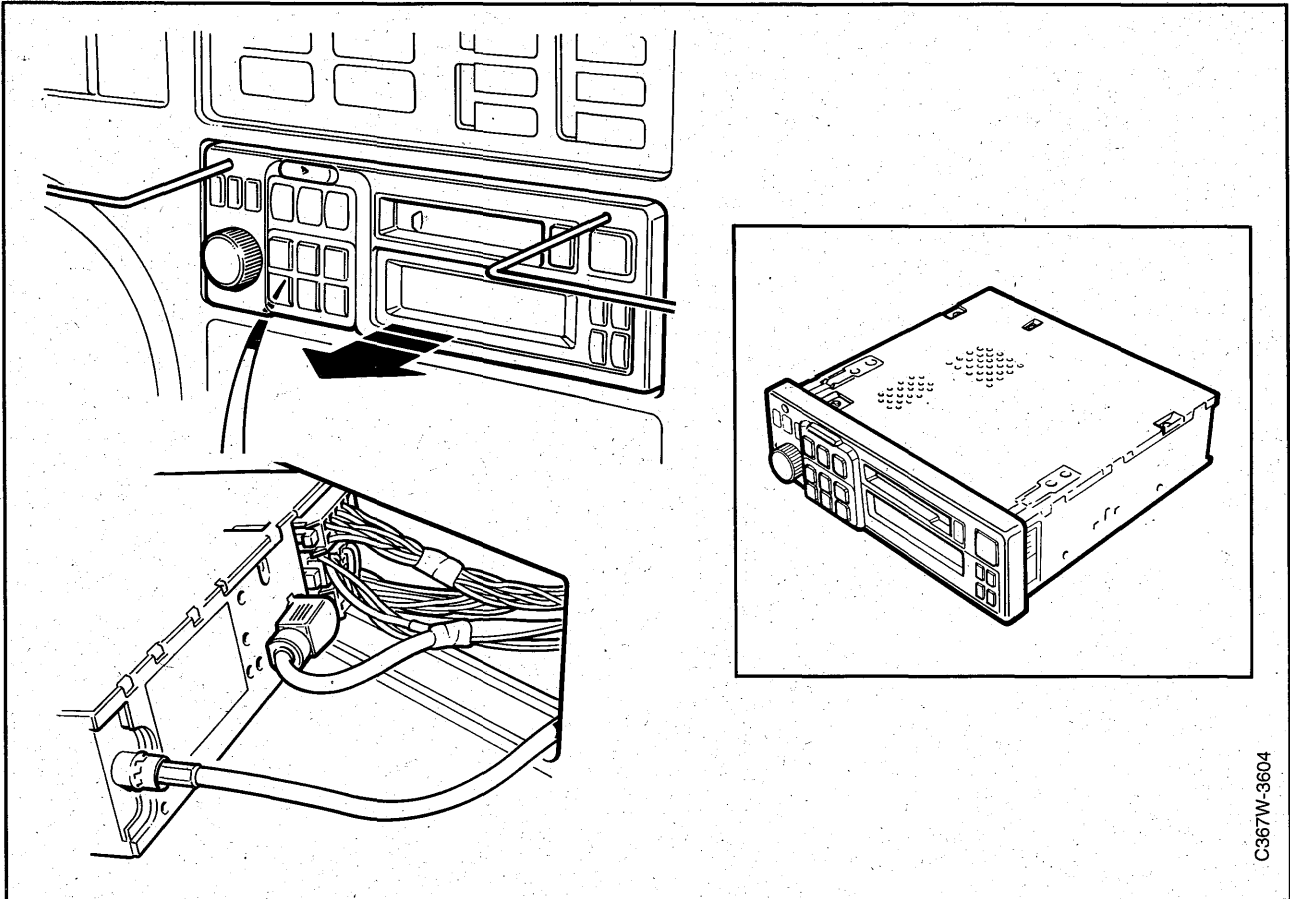

C367W-3604

- 1 Bend out the puller arms of special tool part No. 84 71 161 to a 90° angle and insert it into the two holes on the front of the radio/cassette unit as illustrated.
- 2 Hold the special tool horizontal and pull out the radio and cassette unit.
- 3 Disconnect all connectors from the back of the unit.

Refit in reverse order, but without using the special tool. For coding of radio and cassette, see page 12.

CD player

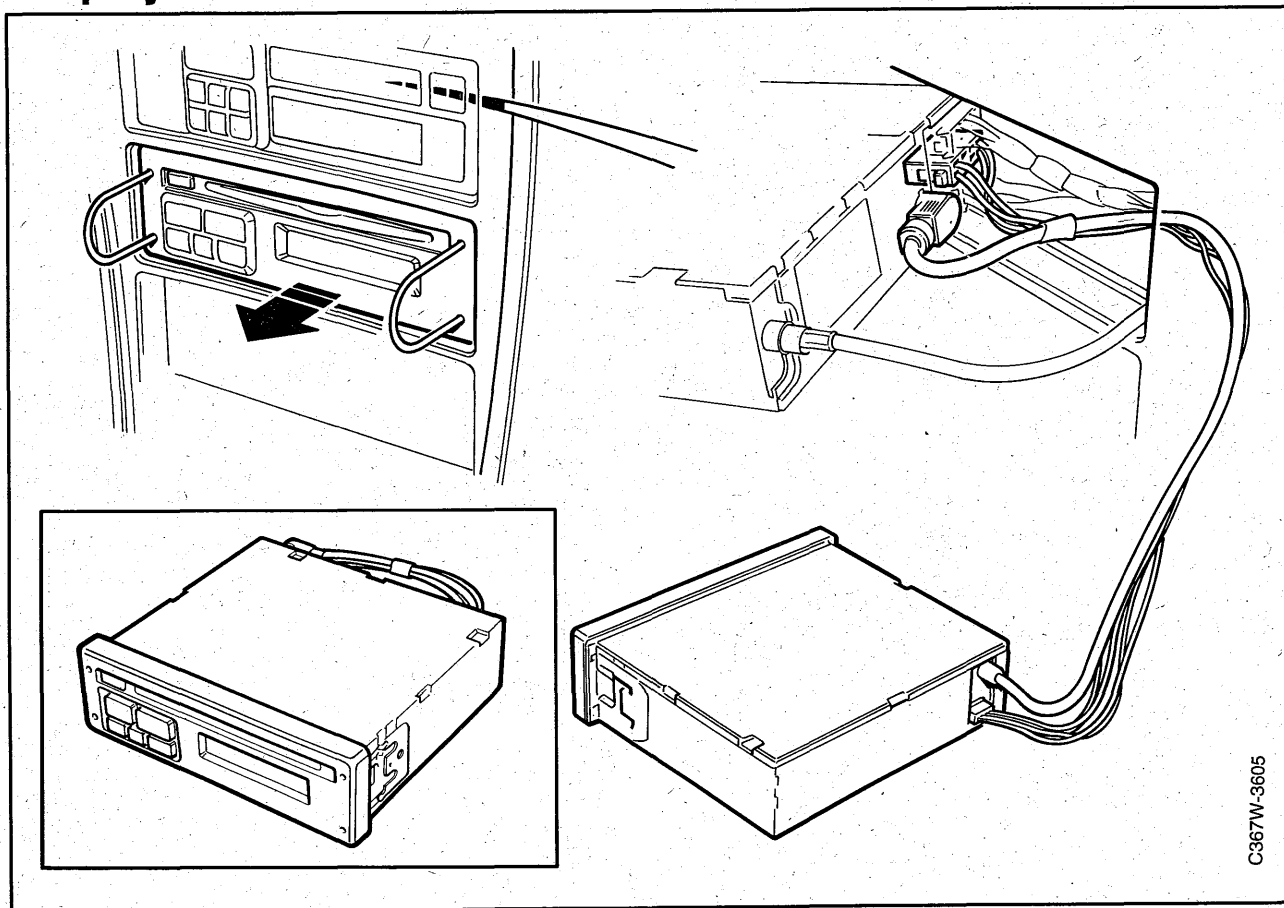

- 1 Pull out the radio and cassette unit to access both connectors from the CD player (one 8-pin and one 13-pin connector). Unplug these connectors.
- 2 Insert special tool part No. 84 71 161 in the holes in the front of the CD player.
- 3 Pull out the CD player.

Refit in reverse order, but without using the special tool.

Amplifier

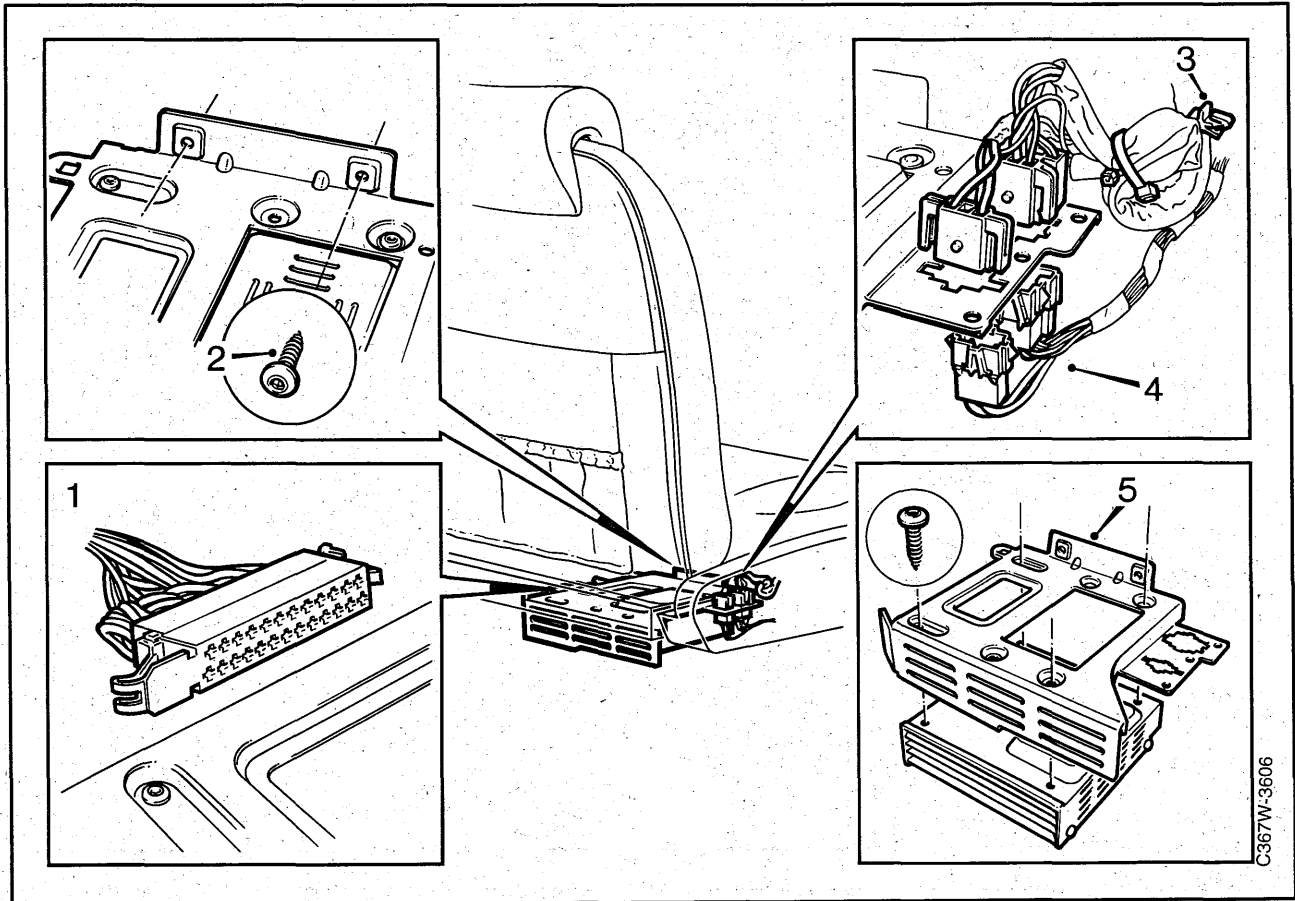

- 1 Slide the right-hand front seat fully forward and unplug the amplifier's 25-pin connector.
- 2 Undo the amplifier bracket.
- 3 Remove the cable tie fixing the cable to the bracket.
- 4 Remove the two electric seat connectors from the bracket.
- 5 Lift out the bracket with the amplifier and remove the amplifier from the bracket.
(Illustration shows Audio System Premium.)

Refit in reverse order.

Front speakers

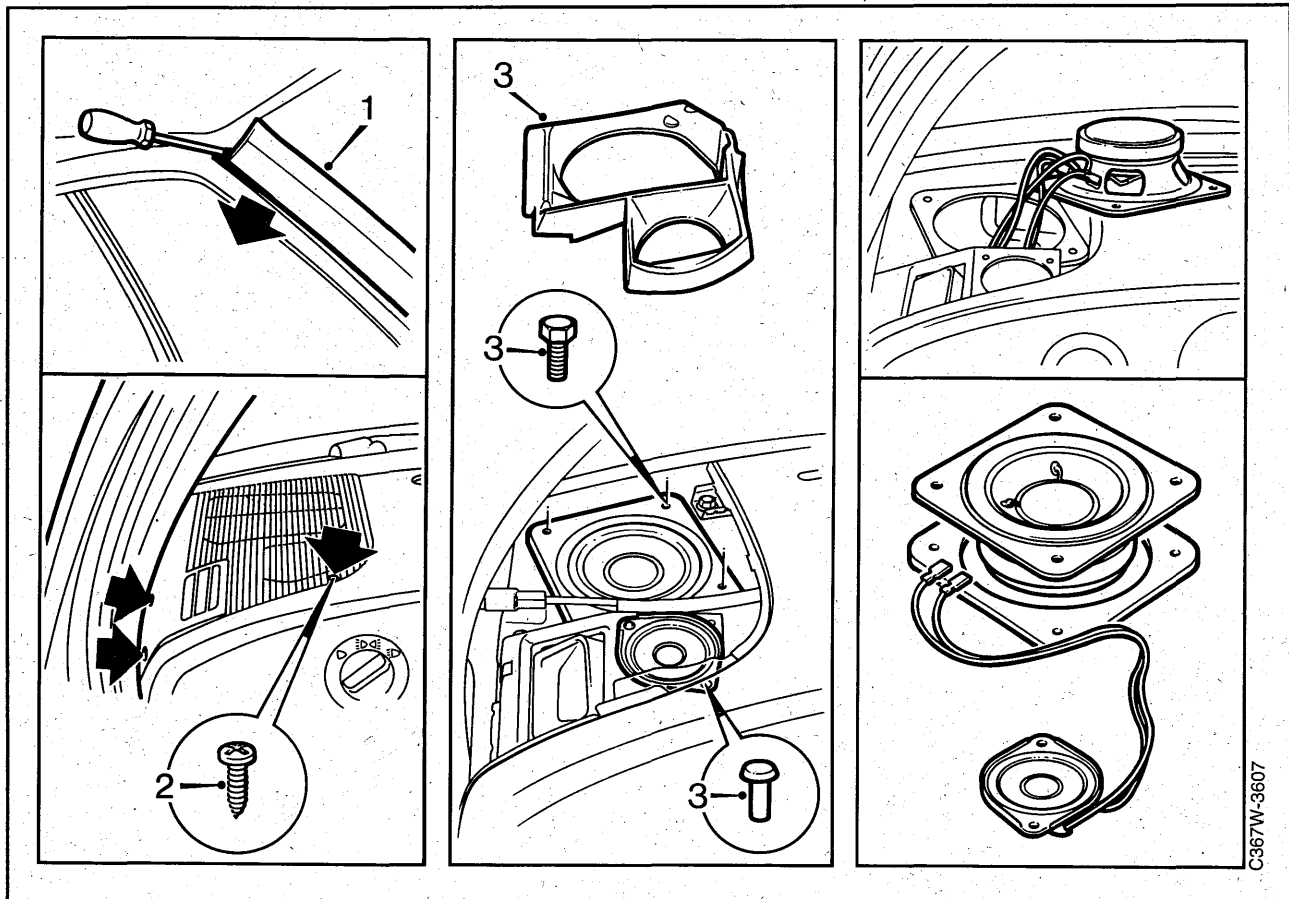

C367W-3607

- 1 Remove the A pillar trim by bending out the upper edge with a screwdriver.
- 2 Undo the three screws holding the speaker grille, lift up the back edge of the grille and pull it out backwards.
- 3 Remove the sealing collar, unscrew the large speaker and remove the two small pins holding the little speaker.
- 4 Unplug the connectors.

Refit in reverse order.

Rear speakers 9000 CD, Audio System Premium

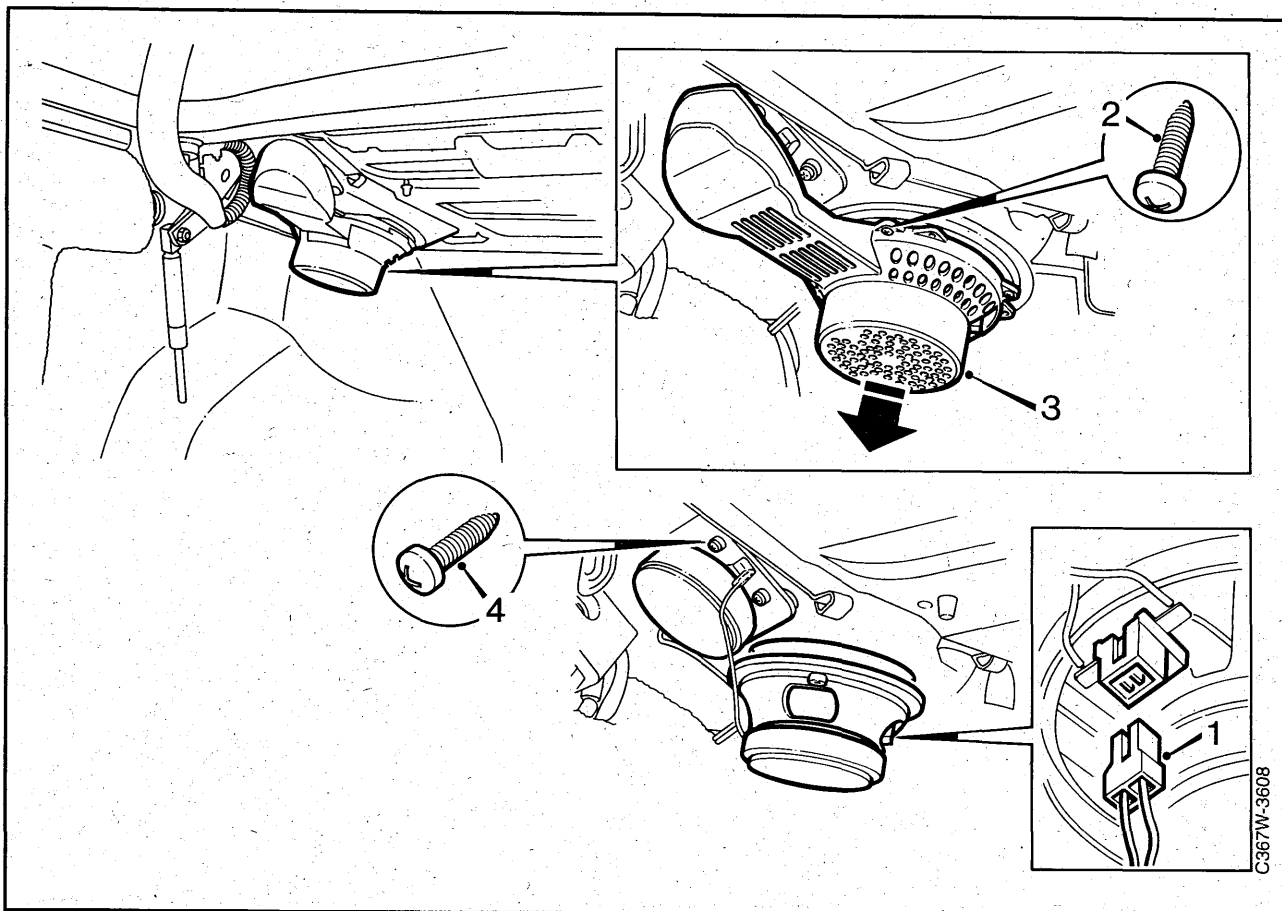

- 1 Unplug the connectors.
 - 2 Remove the screws holding the protective cover and the large speaker.
 - 3 Remove the cover.
 - 4 Remove the screws holding the little speaker.
- Refit in reverse order.

Rear speakers 9000 CD, Audio System Prestige

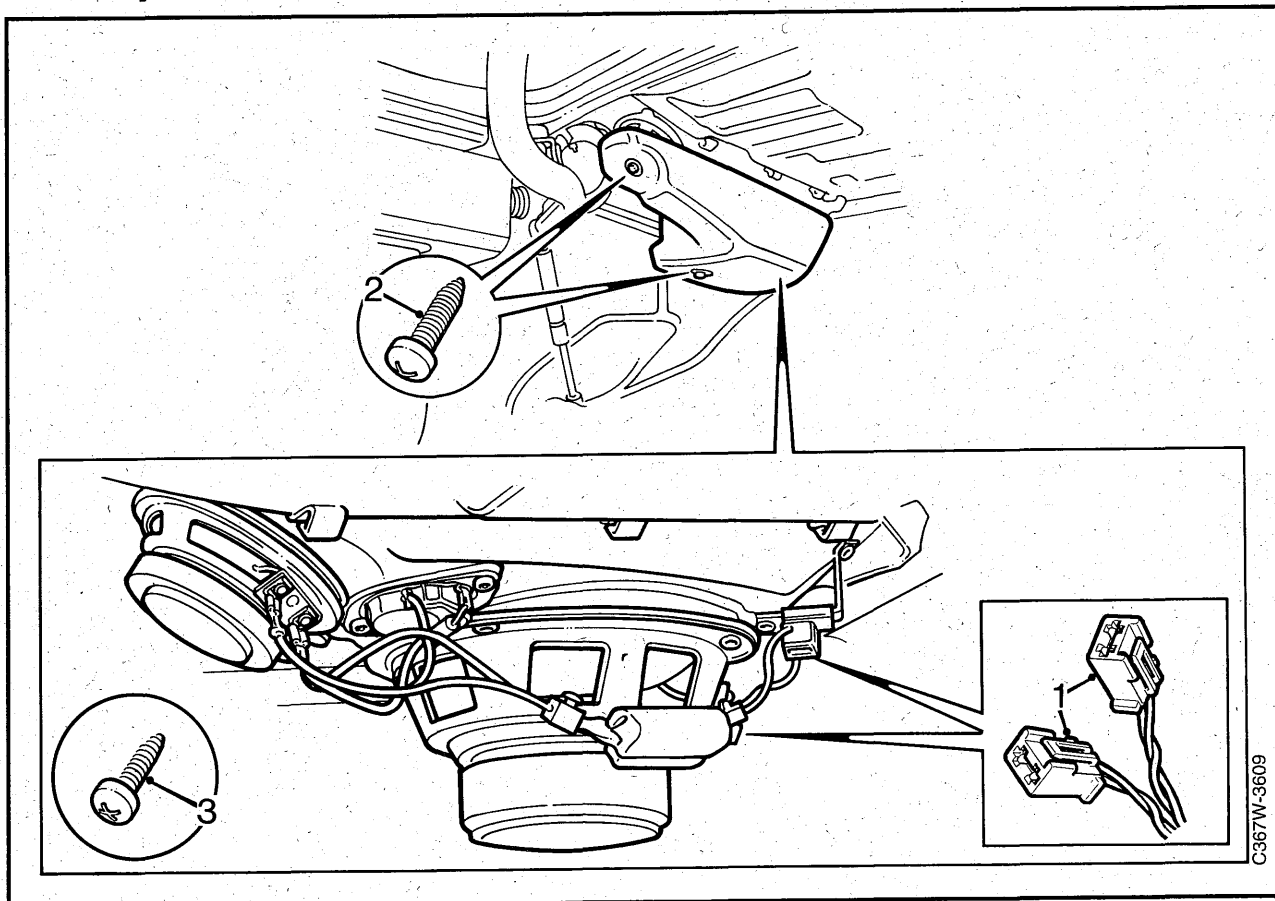

- 1 Unplug the connectors.
- 2 Remove the cover, which is screwed into the speaker magnets.
- 3 Remove the speakers.

Refit in reverse order.

Rear speakers 9000 CS, Audio System Premium

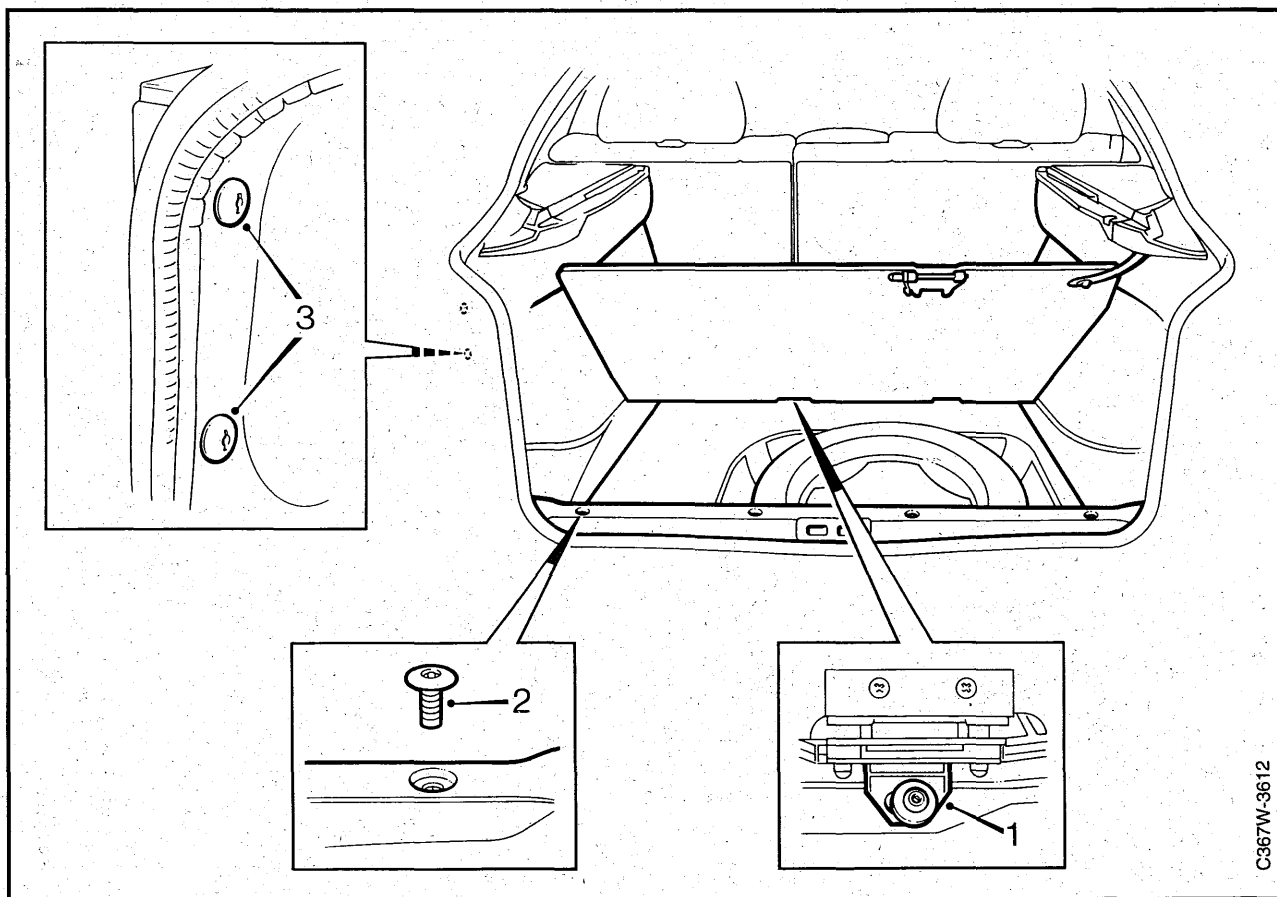

C967W-3612

- 1 Remove the screws holding the luggage compartment floor and lift out the floor.
- 2 Remove the rear sill protection.
- 3 Undo both clips holding the side trim by the rear light cluster.
(Continued on next page).

Rear speakers 9000 CS, Audio System Premium (contd.)

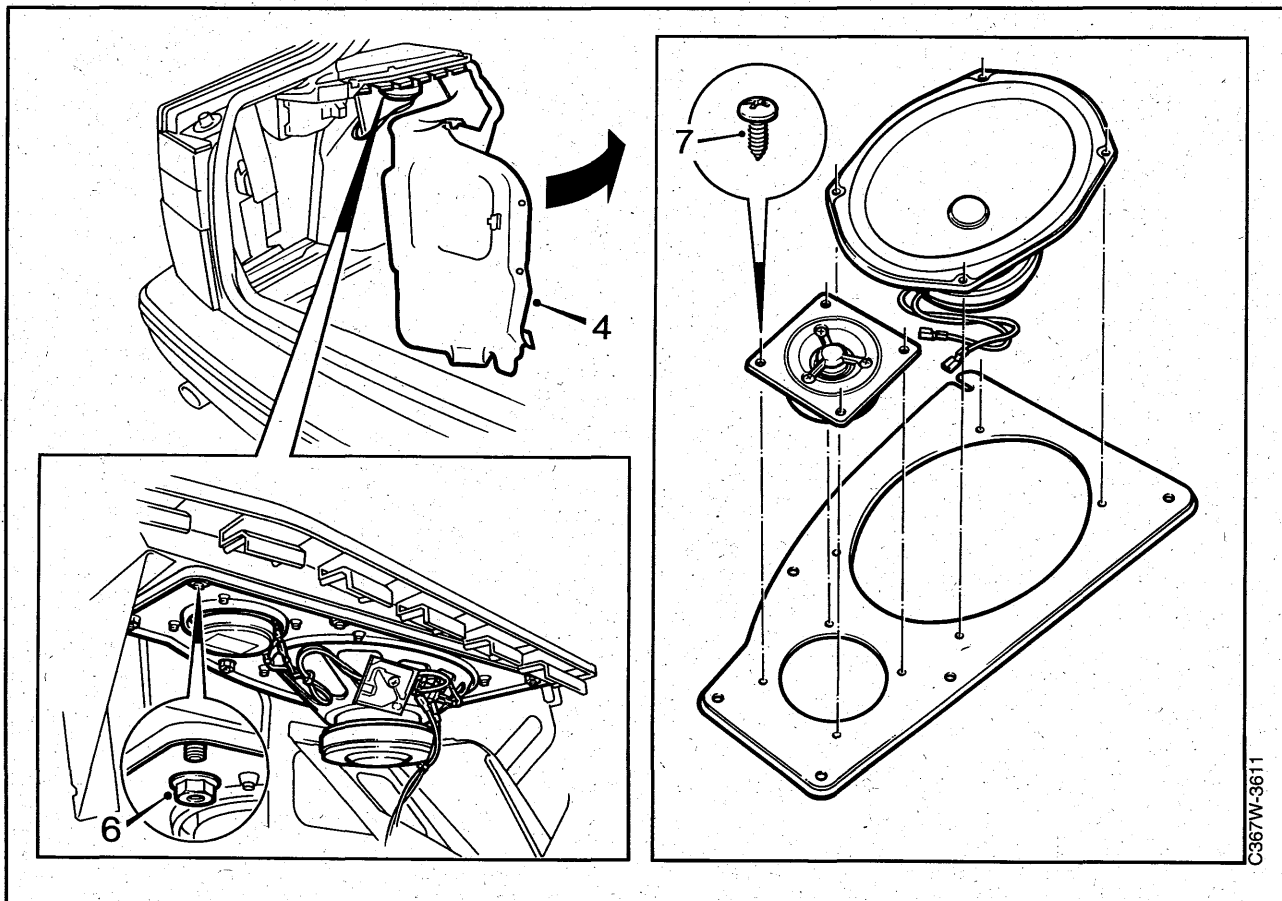

- 4 Fold the trim in the luggage compartment to one side.
- 5 Unplug the connectors.
- 6 Remove the nuts holding the speaker panel.
- 7 Unscrew the speakers from the speaker panel.

Refit in reverse order.

Rear speakers 9000 CS, Audio System Prestige

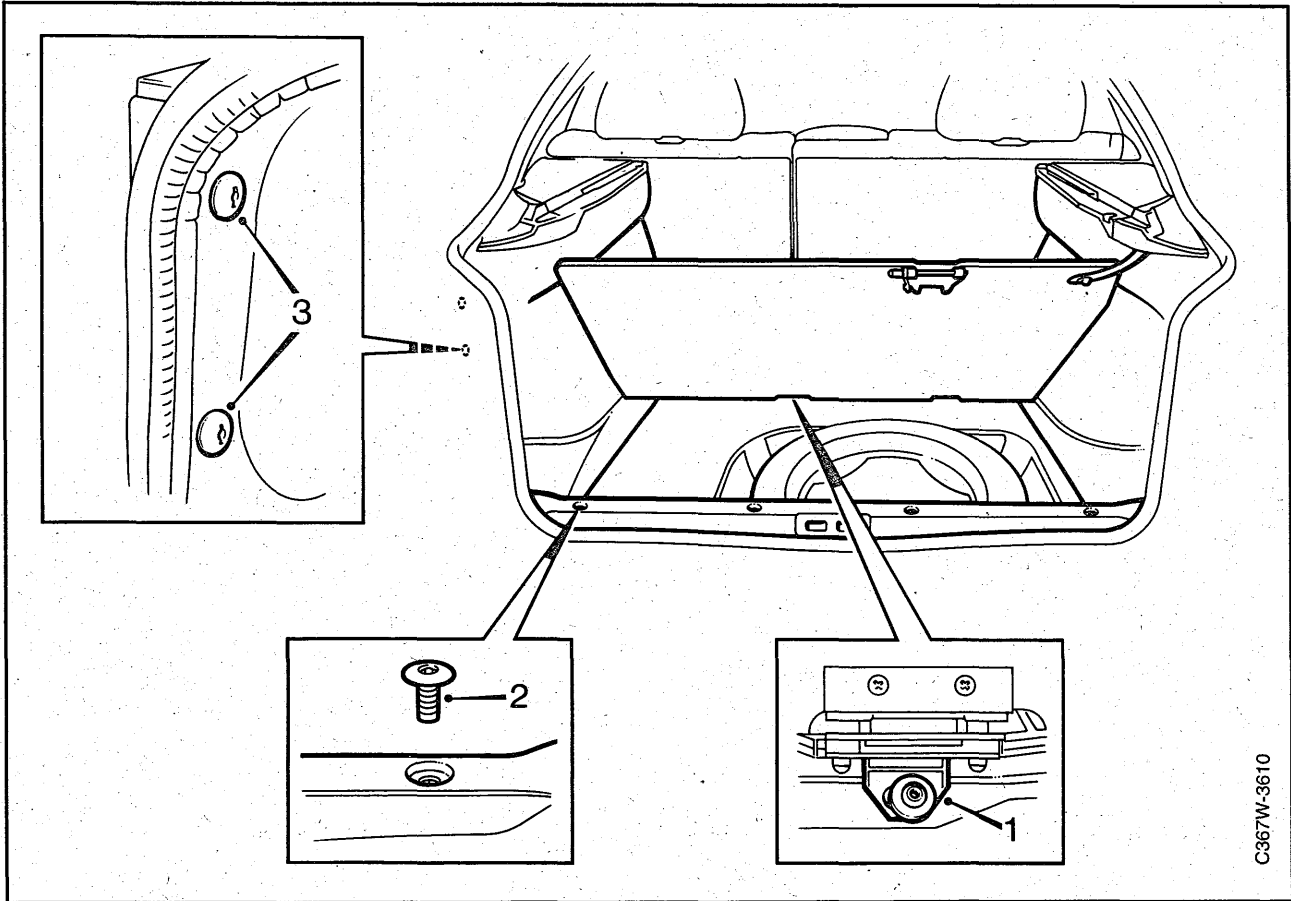

- 1 Remove the screws holding the luggage compartment floor and lift out the floor.
- 2 Remove the rear sill protection.
- 3 Undo both clips holding the side trim by the rear light cluster.
(Continued on next page).

Rear speakers 9000 CS, Audio System Prestige (contd.)

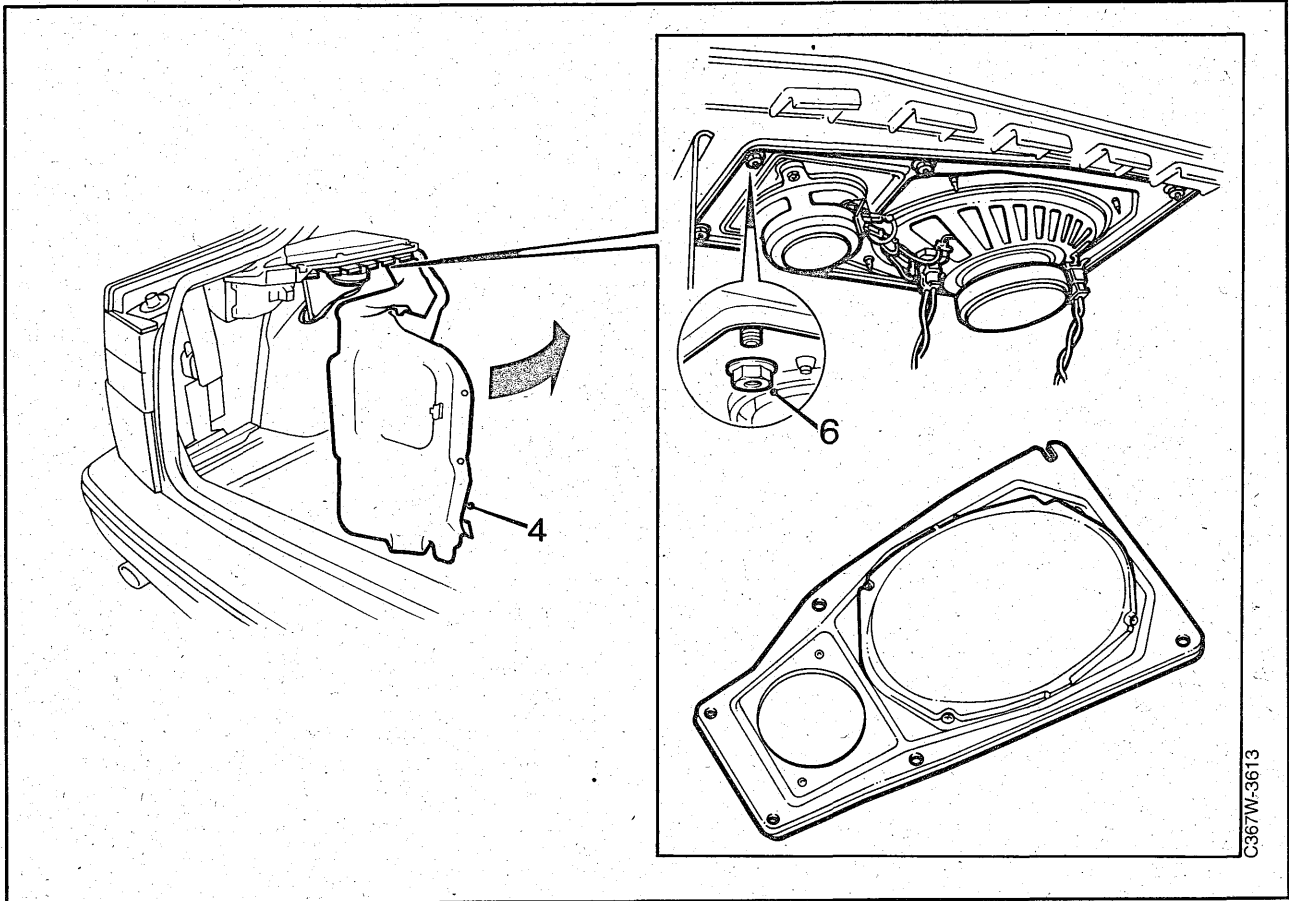

C367W-3613

- 4 Fold the trim in the luggage compartment to one side.
- 5 Unplug the connectors.
- 6 Remove the nuts holding the speaker panel.
- 7 Unscrew the speakers from the speaker panel.

Refit in reverse order.

Power antenna 9000 CD

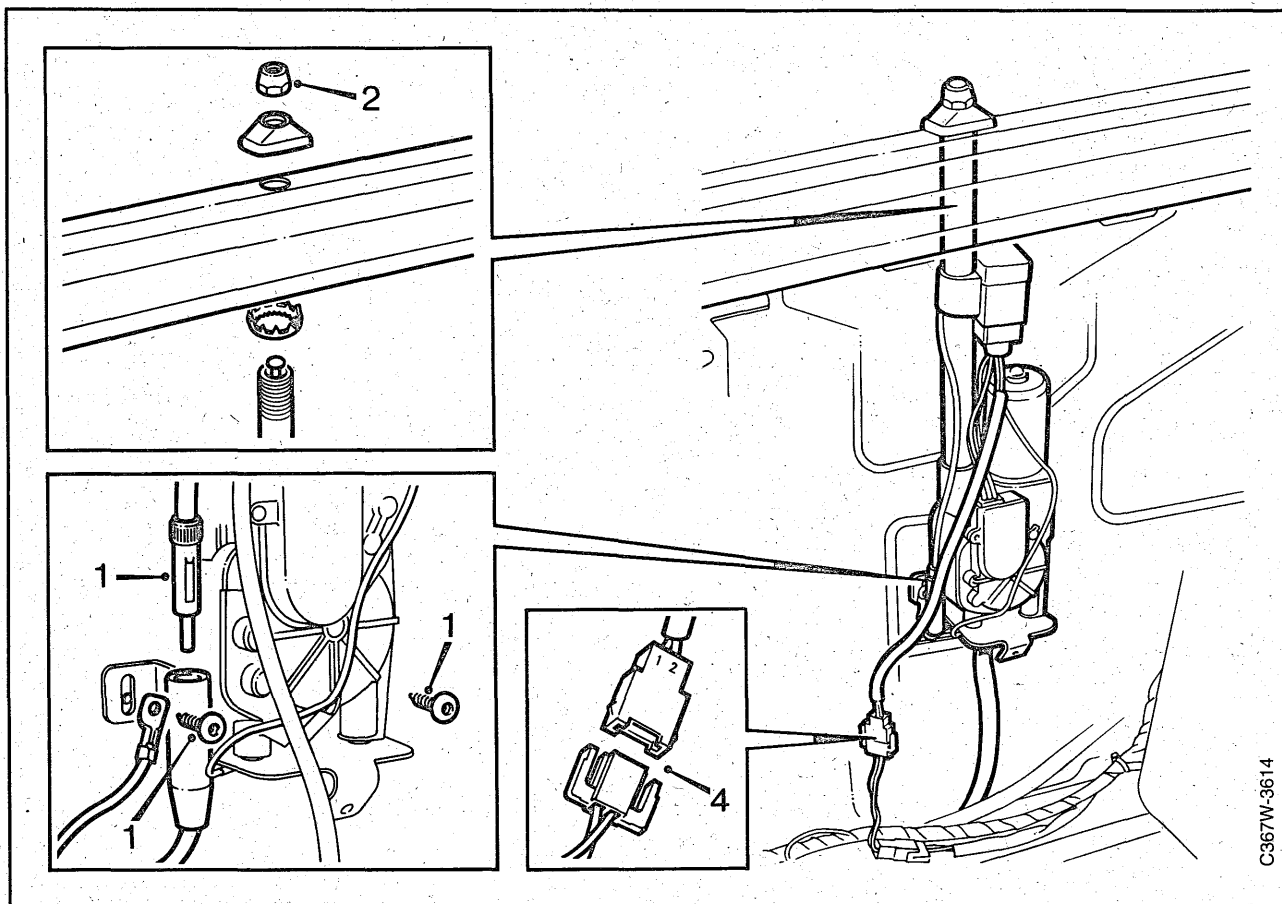

C367W-3614

- 1 Undo the screws securing the power antenna cover.
- 2 Lift the side trim slightly and undo the screws securing the power antenna (the ground cable is attached to one of the screws).
- 3 Undo the nuts at the foot of the antenna and carefully lift the antenna away.
- 4 Disconnect the antenna cable and the 2-pin connector.

Refit in reverse order.

To replace antenna rod, see page 43.

Power antenna 9000 CS

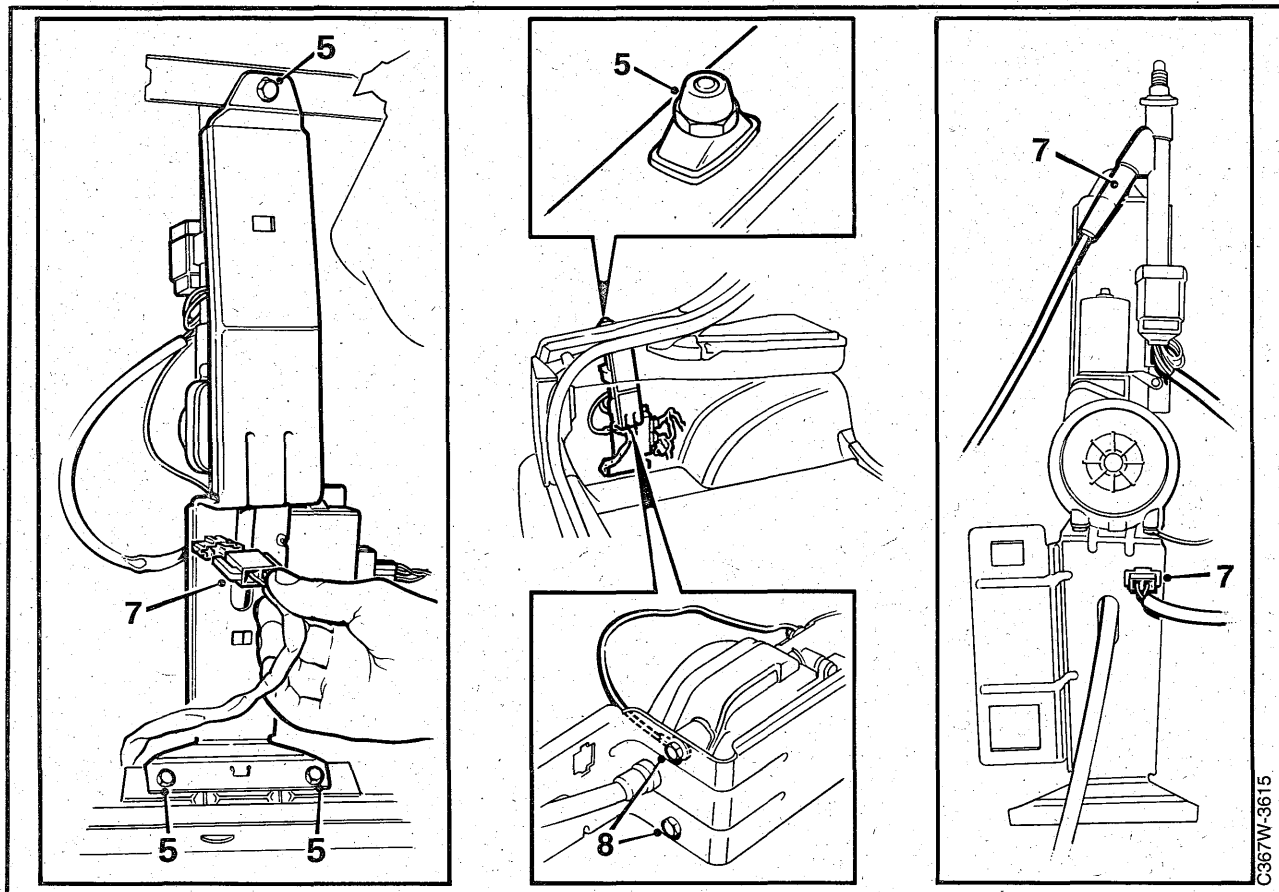

C367W-3615

- 1 Remove the screws holding the luggage compartment floor and lift out the floor.
- 2 Remove the rear sill protection.
- 3 Remove both the side trim clips by the left-hand light cluster.
- 4 Fold away the trim.
- 5 Undo the nut at the foot of the antenna and the three screws holding the antenna bracket.
- 6 Lift out the whole bracket with the antenna and the filament monitor. Remove the filament monitor.
- 7 Disconnect the antenna cable and the 2-pin connector.
- 8 Undo both screws holding the power antenna.
- 9 Remove the motor and disconnect the ground cable from the motor.

Refit in reverse order.

To replace antenna rod, see page 43.

Antenna rod

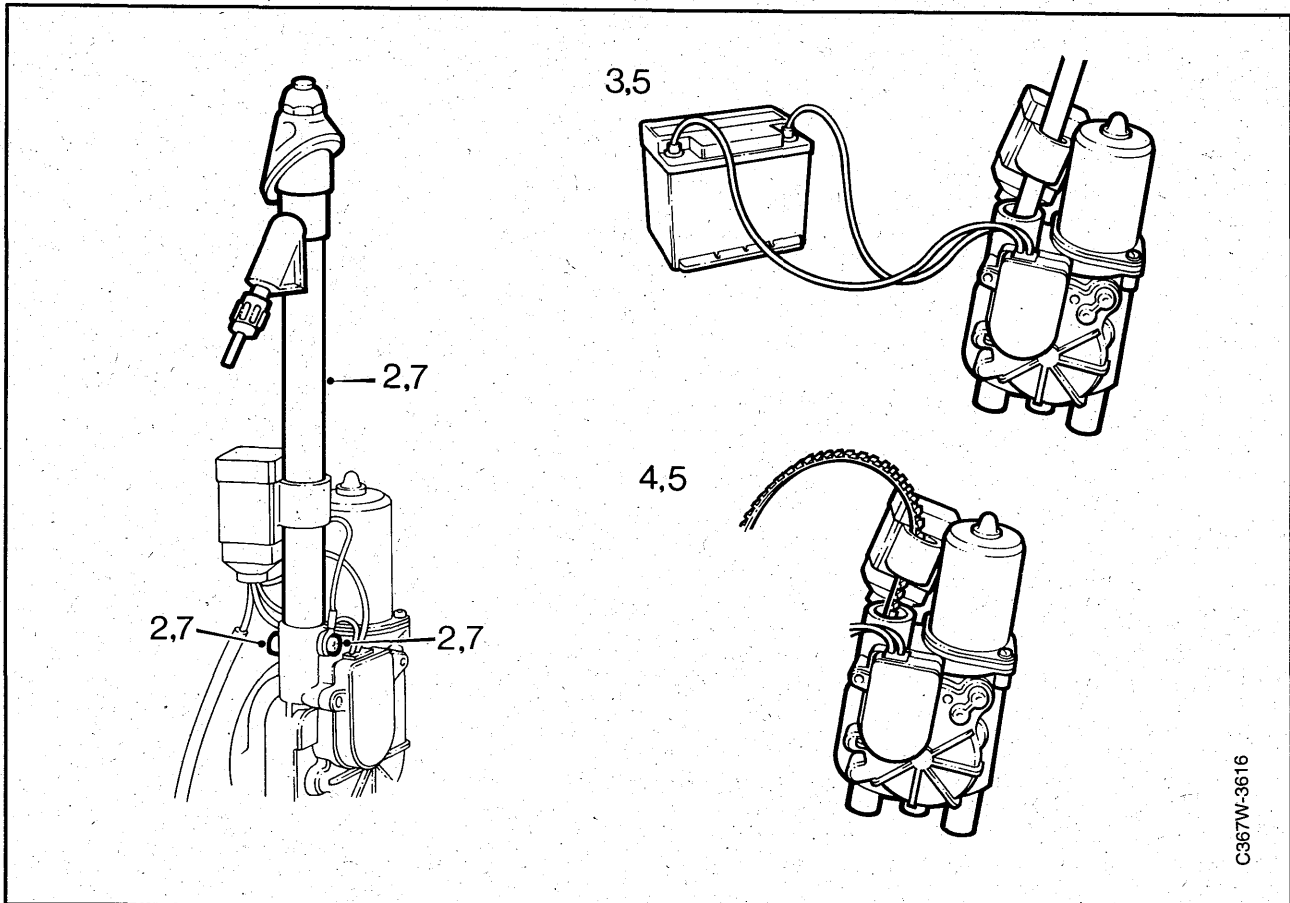

- 1 Remove the power antenna from the car, see page 41 (9000CD) and page 42 (9000 CS).
- 2 Undo the bolts holding the antenna tube and pull it out.
- 3 Connect the antenna motor to a 12 volt battery and wait until the motor has stopped with the antenna in the raised position. Then carefully pull the antenna tube gear rack out of the motor.
- 4 Press the new gear rack into the motor with the teeth towards the motor. Apply a little grease to the gear rack.
- 5 Reconnect the motor to the battery while carefully pushing in the gear rack.

Note

Connect the battery's positive supply in stages to facilitate the rolling in.

- 6 When the entire gear rack has been rolled in, disconnect the battery.
- 7 Fit the antenna tube.

Important

Make sure that the antenna tube is turned the right way.

- 8 Refit the antenna in the car.

Antenna cable

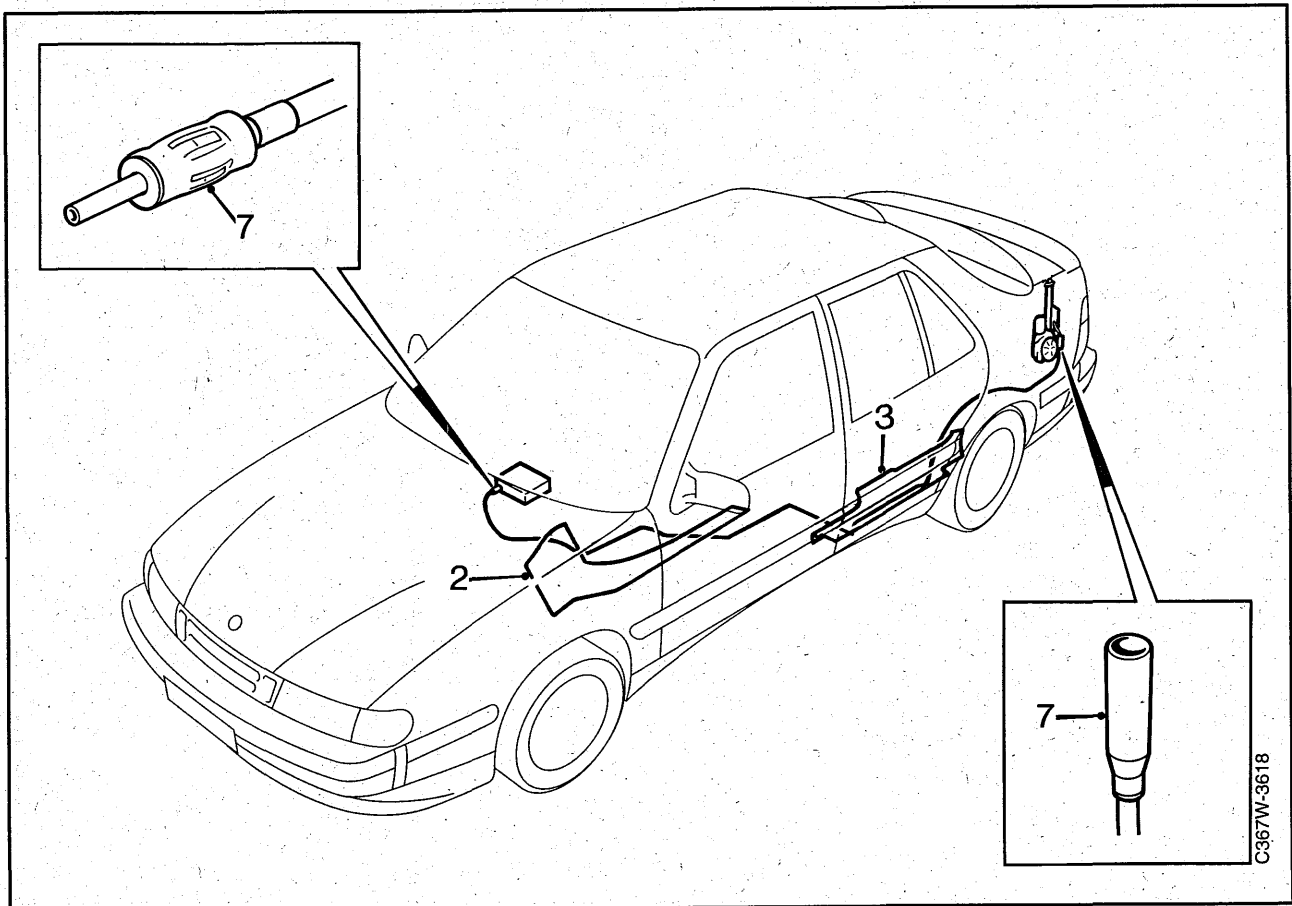

Removal

- 1 Remove the left-hand front seat.
- 2 Remove the left side panel from the center console.
- 3 Remove the sill from the left-hand rear door.
- 4 Fold up the floor carpet to expose the antenna cable.
- 5 Fold the left-hand rear seat cushion forward and fold down the rear backrest.
- 6 Fold aside the trim on the left side of the luggage compartment. (See section for replacing the speakers for instructions.)
- 7 Unplug the connectors.

Fitting

Before removing the old cable, lay out the new one so that all the fixings are in the right place. Fixing is with cable ties at the old fixing points. Connect the new cable and check it is functioning before fitting in reverse order.

Wiring between radio unit and amplifier

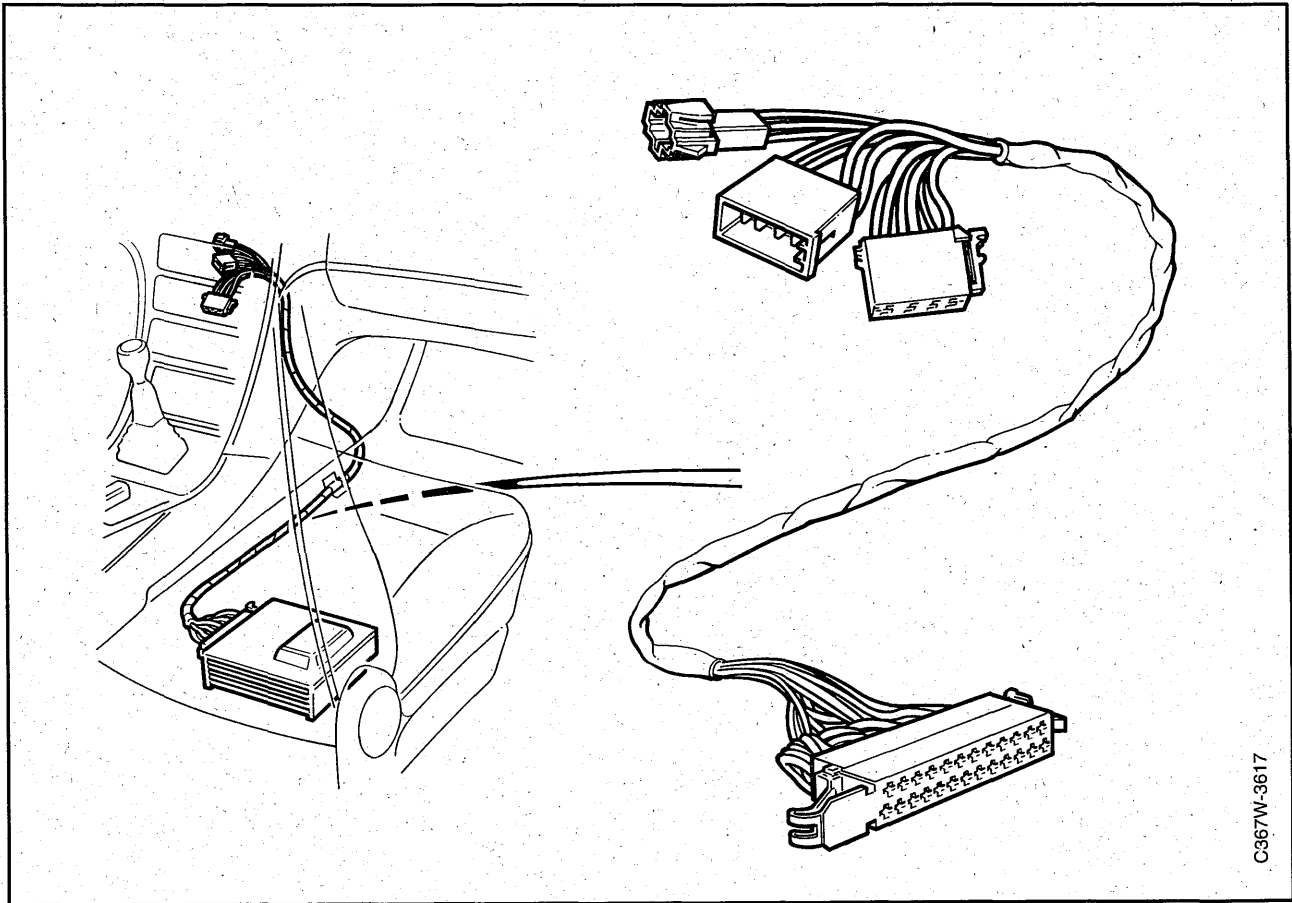

- 1 Slide the right-hand front seat fully back and raise the front seat.
- 2 Remove the two front and the left-hand rear seat bolts.
- 3 Remove the cover piece in the center console and fold away the carpet on the seat member.
- 4 Unplug the wiring connections.
- 5 Remove the wiring from the amplifier, under the right-hand front seat to the center console.

Refit in reverse order.

Connectors and grounding points

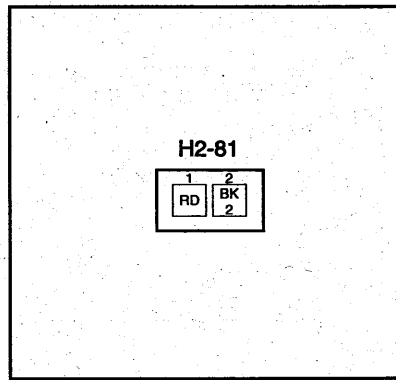
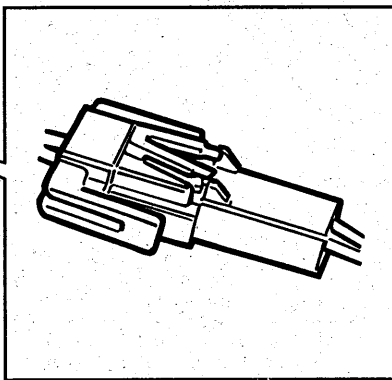
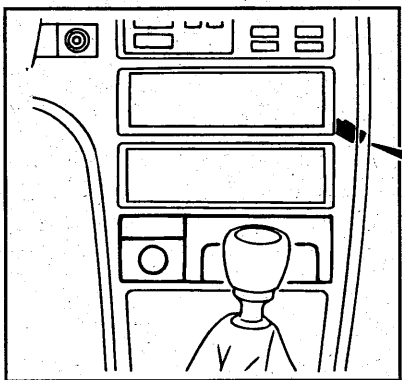
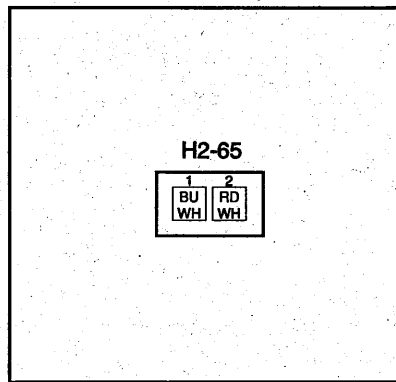
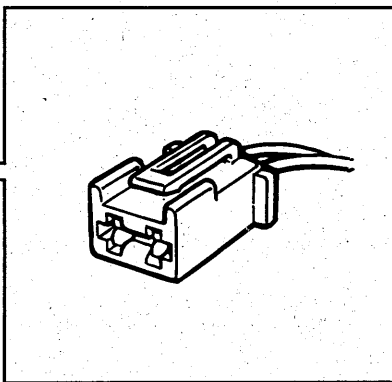
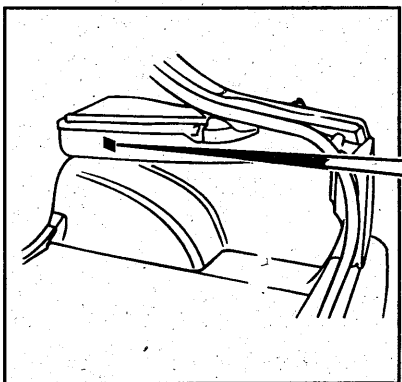
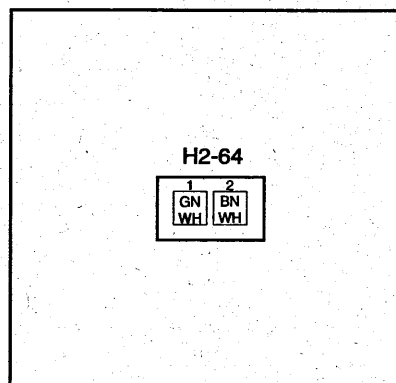
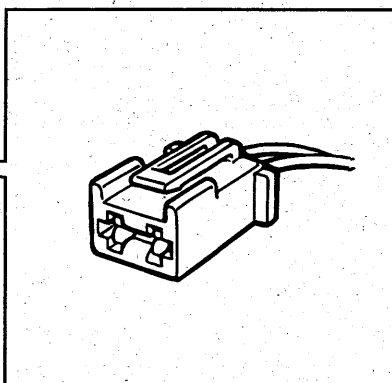
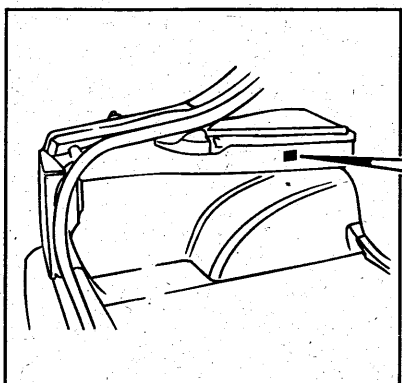
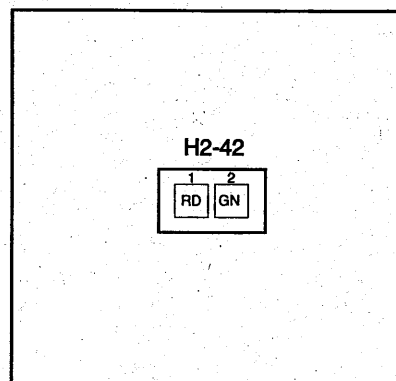
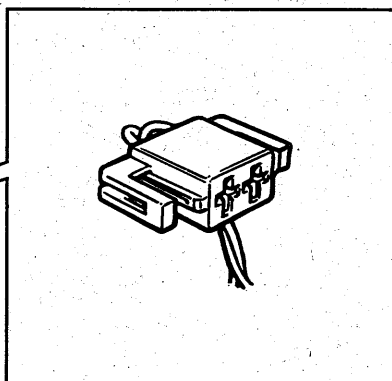
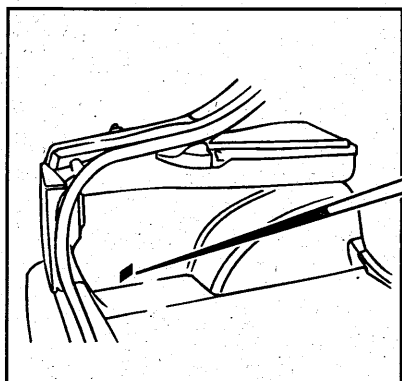

C367W-3619

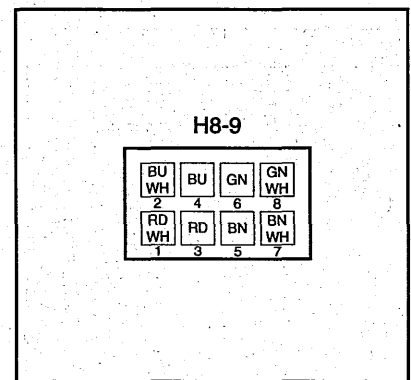
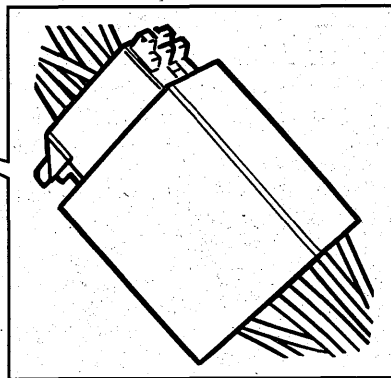
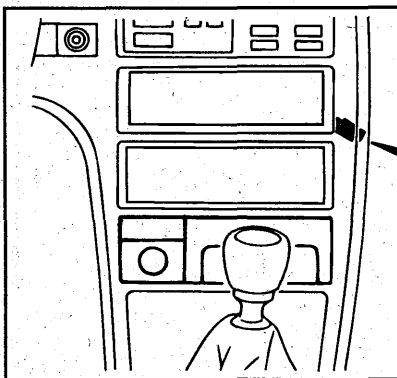
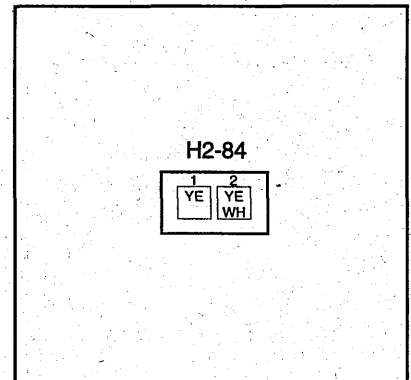
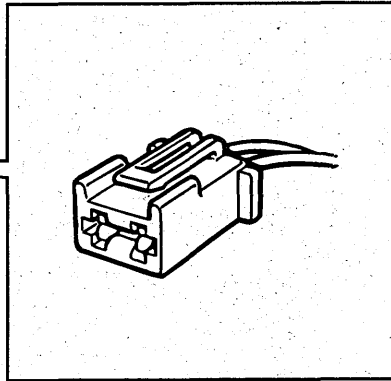
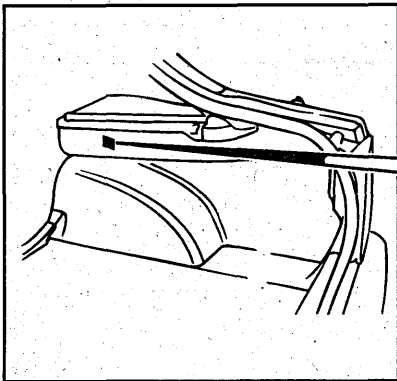
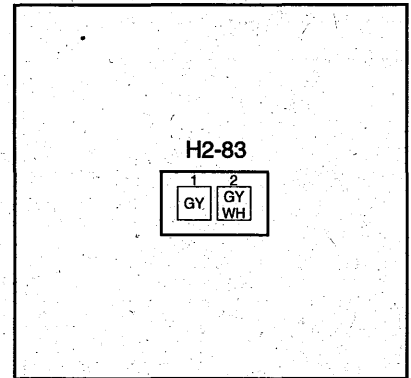
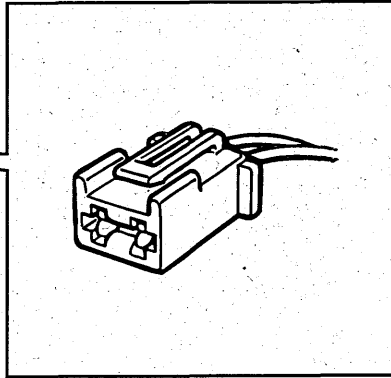
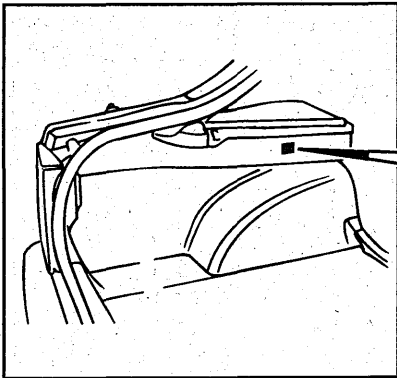
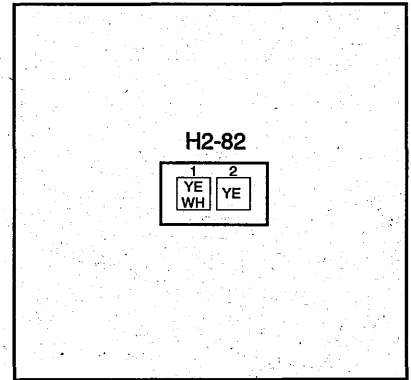
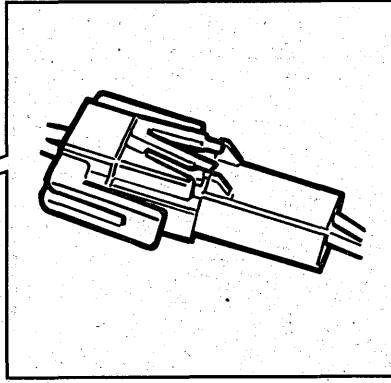
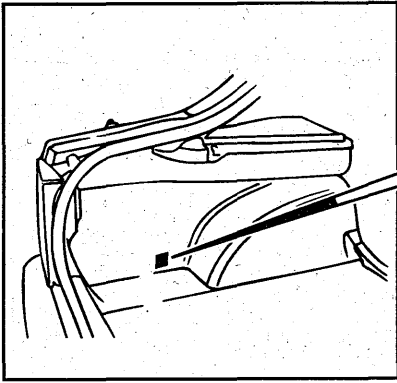

C367W-3620

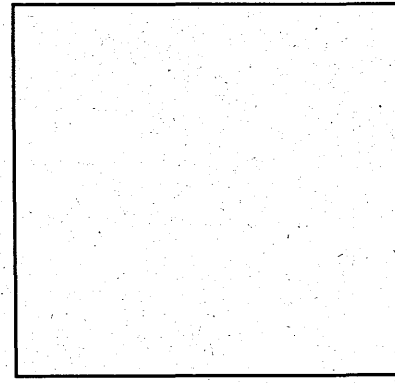
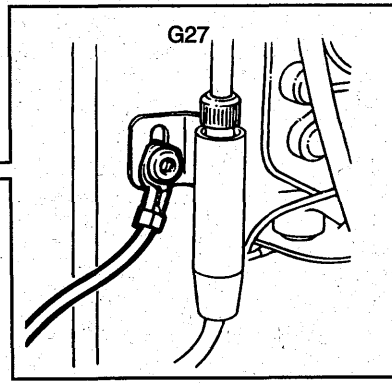
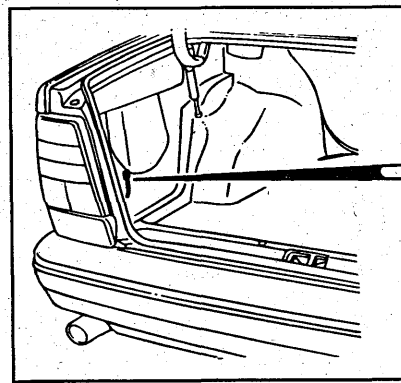
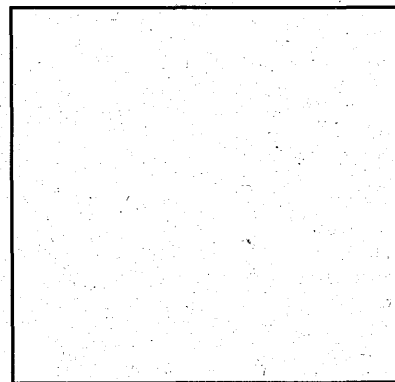
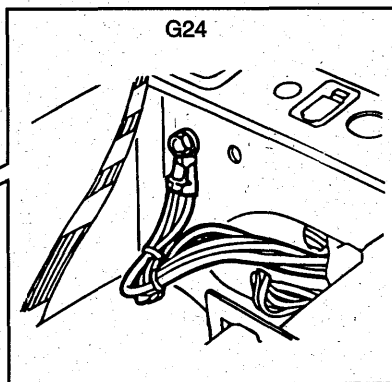
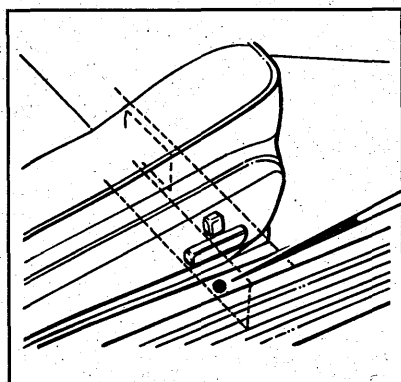
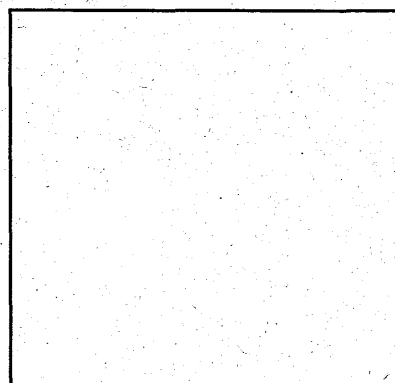
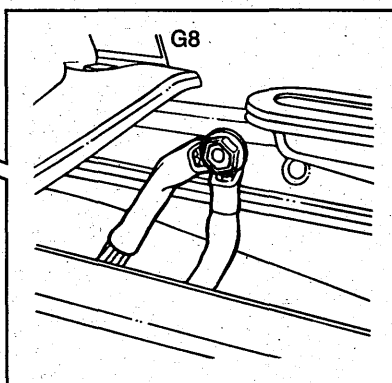
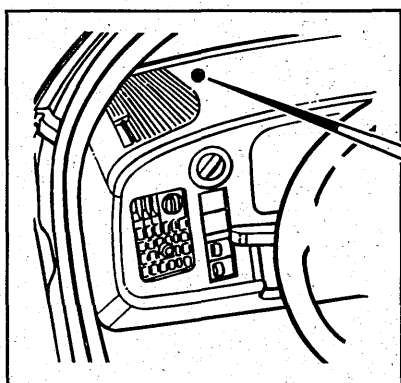
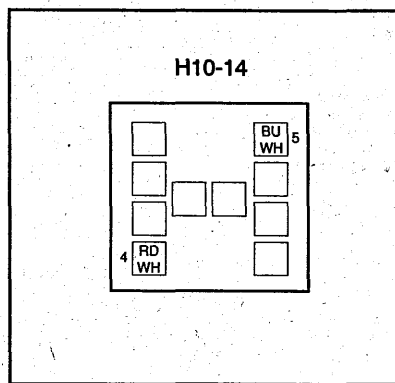
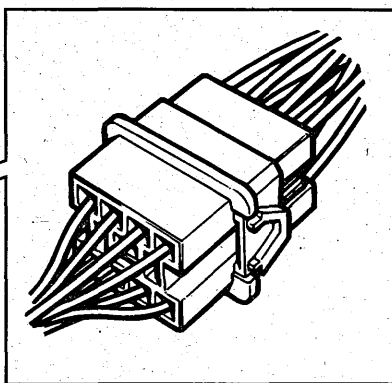
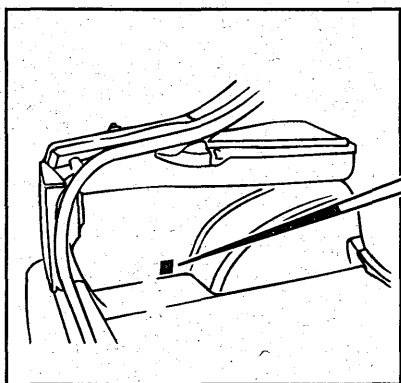

C367W-3621

Electrical diagram

Electrical diagram, Audio System Premium (EU)

List of components

16	Rheostat
20	Ignition switch
230	Battery
265	Power antenna
266	Speakers
350	CD player
353	Radio and cassette unit
354	Amplifier
355	CD changer
G8	Grounding point on the left side under the instrument panel
G27	Grounding point by the antenna bracket

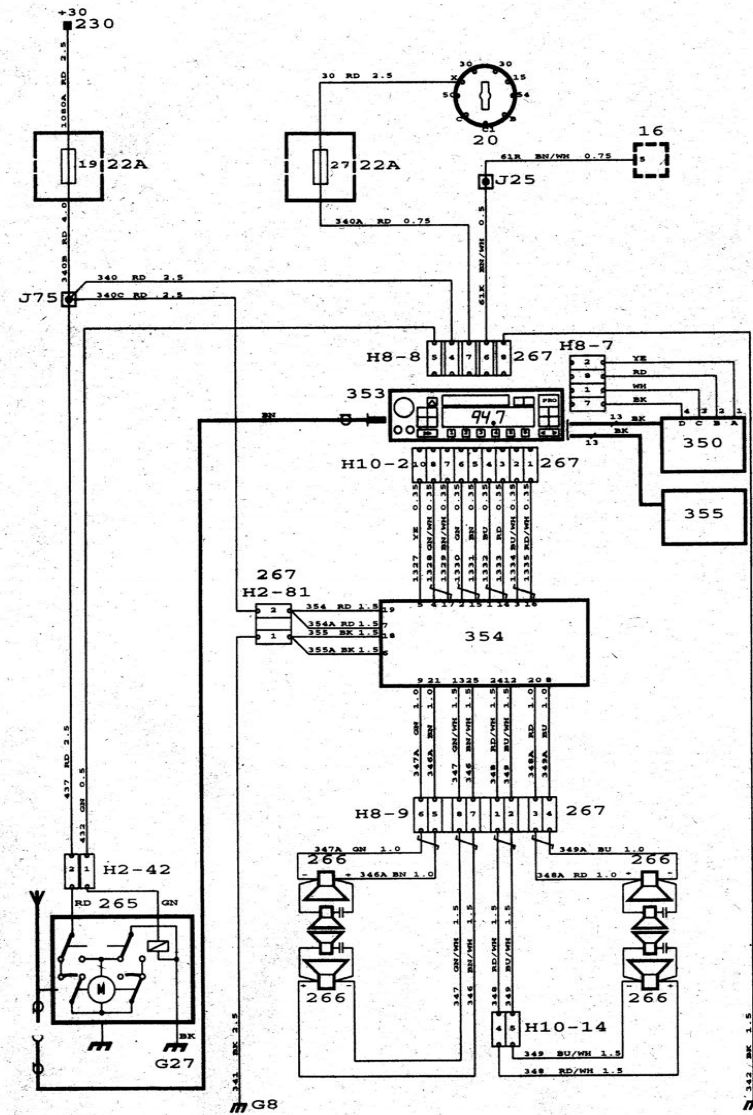

Electrical diagram, Audio System Premium (US)

List of components

16	Rheostat
20	Ignition switch
230	Battery
265	Power antenna
266	Speakers
349	Radio and cassette unit
350	CD player
354	Amplifier
355	CD changer
G8	Grounding point on the left side under the instrument panel
G24	Grounding point under right-hand front seat
G27	Grounding point by the antenna bracket

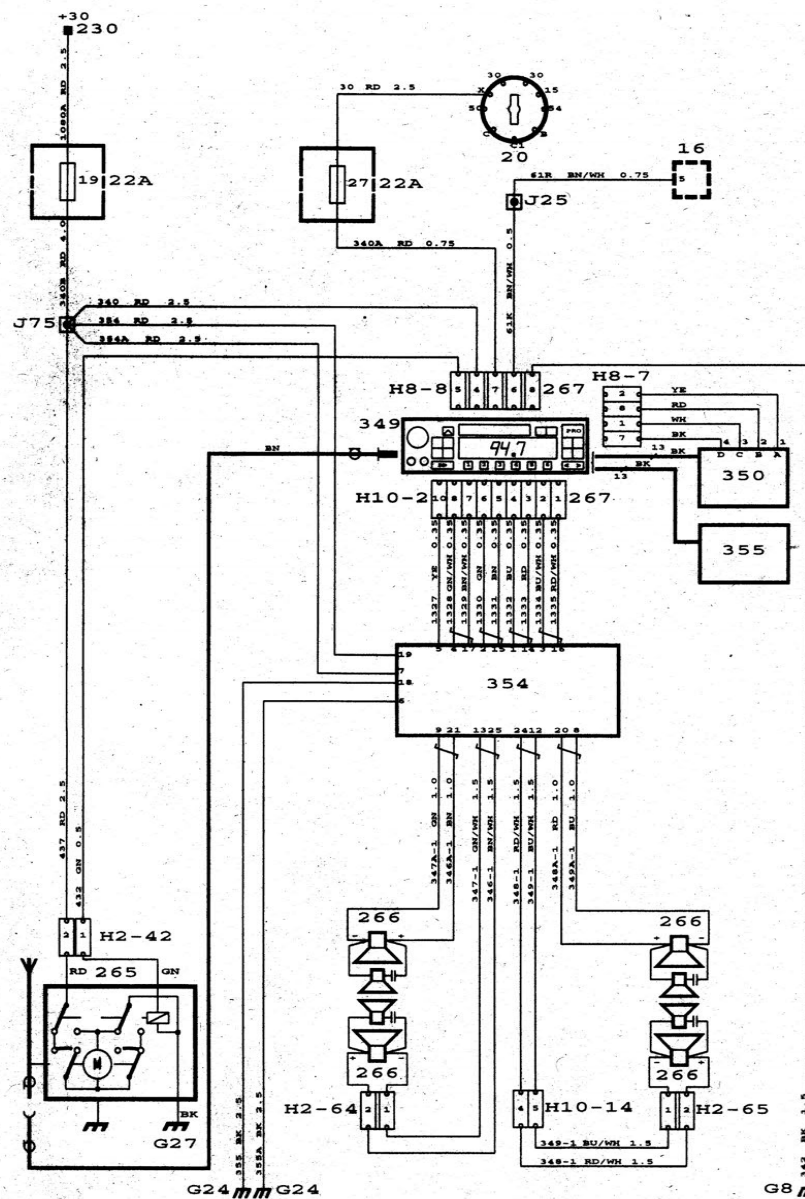

Electrical diagram, Audio System Prestige

List of components

16	Rheostat
20	Ignition switch
230	Battery
265	Power antenna
266	Speakers
349	Radio and cassette unit
350	CD player
351	Amplifier
355	CD changer
G8	Grounding point on the left side under the instrument panel
G24	Grounding point under right-hand front seat
G27	Grounding point by the antenna bracket

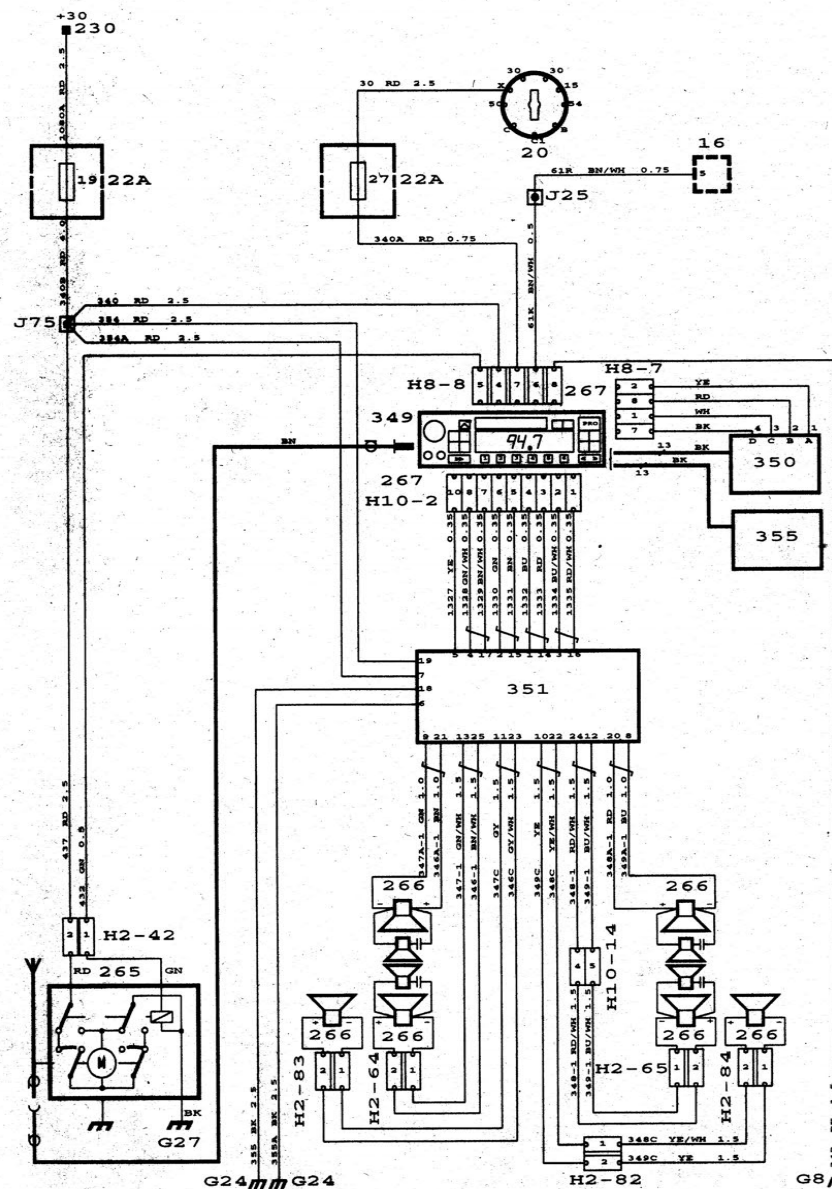



SAAB

Saab Automobile AB
Trollhättan, Sweden

Ordering No. 357723. English edition. Printed in Sweden. © Saab Automobile AB, 1994.

